

●LED TYPE

LED INDICATOR



# ROUND TYPE LED INDICATOR



## FEATURES

### ■Wide variety for different uses

A broad range of models from 10 to 30 mm in diameter are available. The brightness equivalent to that of an incandescent lamp has been achieved through our original technological efforts.

### ■Compatible with different types of power sources

These indicators comply with requirements of various power sources which allows connections without decreasing voltage from the control power supply for each facility.

## SPECIFICATIONS (RATINGS, PERFORMANCE)

| Specification \ Type              | TMP   | TSPA               | HXL                             | JXL                | PXL                |
|-----------------------------------|---|--------------------|---------------------------------|--------------------|--------------------|
| Rated insulation voltage (Ui)     | 250V  |                    |                                 |                    |                    |
| Mounting hole size                | $\phi 10.1^{+0.2}$  | $\phi 16.2^{+0.2}$ | $\phi 22.3^{+0.4}$              | $\phi 25.5^{+0.5}$ | $\phi 30.5^{+0.5}$ |
| Screw size                        | Faston tab #110   | M3×6               | M3.5×8                          | M3.5×8             | M3.5×8             |
| Rated current                     | 8mA   | 6mA                | 11mA                            | 11mA               | 11mA               |
| Lightning impulse                 | ----- $\pm 4.5kV$ ----- $\pm 7kV$ -----<br>3 times for each pole (1.2 / 50 $\mu$ s) (Whole live part to mounting panel) |                    |                                 |                    |                    |
| Recognition distance              | 10m (1,000 LX in illuminance on applicable panel)   |                    |                                 |                    |                    |
| Power-frequency withstand voltage | 2,000V AC   |                    | ----- 2,500V AC -----<br>1 min. |                    |                    |
| Operating temperature             | -20 to 55°C   | -25 to 55°C        | -20 to 40°C                     |                    |                    |
| Storing temperature               | -25 to 75°C   | -40 to 75°C        | -25 to 65°C                     |                    |                    |
| Altitude                          | 2,000 m max.  |                    |                                 |                    |                    |
| Weight                            | 15g   | 20g                | 20g                             | 25g                | 30g                |

## HOW TO ORDER

[TMPN type]

### TMPN-024-RB (S)

| Basic type |             |      |                    | Supply voltage |       |      |             | Lens color |       |      |                 | Frame color (B only) |      | Lens type |  |
|------------|-------------|------|--------------------|----------------|-------|------|-------------|------------|-------|------|-----------------|----------------------|------|-----------|--|
| Code       | Voltage     | Code | Voltage            | Code           | Color | Code | Color       | Code       | Color | Code | Color           | Code                 | Type |           |  |
| 005        | 5V AC / DC  | 048  | 48V AC / DC        | R              | Red   | O    | Orange      | B          |       | (S)  | Round type      |                      |      |           |  |
| 012        | 12V AC / DC | 063  | 63.5V AC / DC      | G              | Green | W    | Milky white |            |       | (E)  | Round flat type |                      |      |           |  |
| 024        | 24V AC / DC | 110  | 100 / 110V AC / DC |                |       |      |             |            |       |      |                 |                      |      |           |  |

\* GPT (Ground Potential Transformer, special spec) is also available. Please contact us for detail.

High-brightness type

[TMPH type]

### TMPH-024-RB (S)

| Basic type |             |      |                    | Supply voltage |       |      |             | Lens color |       |      |                 | Frame color (B only) |      | Lens type |  |
|------------|-------------|------|--------------------|----------------|-------|------|-------------|------------|-------|------|-----------------|----------------------|------|-----------|--|
| Code       | Voltage     | Code | Voltage            | Code           | Color | Code | Color       | Code       | Color | Code | Color           | Code                 | Type |           |  |
| 005        | 5V AC / DC  | 048  | 48V AC / DC        | R              | Red   | W    | Milky white | B          |       | (S)  | Round type      |                      |      |           |  |
| 012        | 12V AC / DC | 063  | 63.5V AC / DC      | +G             | Green | O    | Orange      |            |       | (E)  | Round flat type |                      |      |           |  |
| 024        | 24V AC / DC | 110  | 100 / 110V AC / DC | +BL            | Blue  |      |             |            |       |      |                 |                      |      |           |  |

\* No 5V versions are available in G (green) and BL (blue).

[TSPA type]

### TSPA-DC024-RB (E)

| Basic type |               |       |               | Supply voltage |        |      |             | Lens color |       |      |                 | Frame color |      | Lens type |  |
|------------|---------------|-------|---------------|----------------|--------|------|-------------|------------|-------|------|-----------------|-------------|------|-----------|--|
| Code       | Voltage       | Code  | Voltage       | Code           | Color  | Code | Color       | Code       | Color | Code | Color           | Code        | Type |           |  |
| DC012      | 12V DC        | AC024 | 24V AC        | R              | Red    | O    | Orange      | B          |       | (S)  | Round type      |             |      |           |  |
| DC024      | 24V DC        | AC048 | 48V AC        | G              | Green  | W    | Milky white |            |       | (E)  | Round flat type |             |      |           |  |
| DC110      | 100 / 110V DC | AC063 | 63.5V AC      | Y              | Yellow | C    | Clear       |            |       |      |                 |             |      |           |  |
| DC125      | 125V DC       | AC110 | 100 / 110V AC | BL             | Blue   |      |             |            |       |      |                 |             |      |           |  |
| DC220      | 220V DC       | AC220 | 200 / 220V AC |                |        |      |             |            |       |      |                 |             |      |           |  |
|            |               | AC240 | 240V AC       |                |        |      |             |            |       |      |                 |             |      |           |  |

\* 220V DC and 240V AC are special voltage spec.



# ROUND TYPE LED INDICATOR

## HOW TO ORDER

[HXL · JXL · PXL type]

### HXL-110-RB(S)

Basic type

| Code | Mounting hole (φ) |
|------|-------------------|
| HXL  | 22                |
| JXL  | 25                |
| PXL  | 30                |

Display color

| Code | Color                    | Code | Color              |
|------|--------------------------|------|--------------------|
| R    | Red                      | O    | Orange             |
| G    | Green                    | W    | Milky white        |
| Y    | Yellow <sup>*2</sup>     | B    | Blue <sup>*2</sup> |
| P    | Pure white <sup>*2</sup> |      |                    |

Frame color

| Code | Color                |
|------|----------------------|
| B    | Black (N1.5)         |
| CR   | Chrome <sup>*3</sup> |

<sup>\*3</sup> Chrome is only for PXL.

Lens type

| Code | Type       |
|------|------------|
| (S)  | Round type |

Supply voltage

| Code | Voltage          | Code | Voltage                    |
|------|------------------|------|----------------------------|
| 024  | 24V AC / DC      | 125  | 125V AC / DC               |
| 048  | 48V AC / DC      | 220  | 200/220V AC / DC           |
| 110  | 100/110V AC / DC | 240  | 240V AC / DC <sup>*1</sup> |

<sup>\*2</sup> Y, B and P are special spec.

<sup>\*1</sup> 240V AC/DC is available only for HXL type (special voltage).

### LED chip number for HXL / JXL / PXL LED unit

\* LED unit for JXL and PXL is common (PXL-LED).

| Color           | HXL | JXL | PXL |
|-----------------|-----|-----|-----|
| R (Red)         | 2   | 4   | 4   |
| O (Orange)      | 2   | 4   | 4   |
| W (Milky white) | 2   | 4   | 4   |
| Y (Yellow)      | 2   | 4   | 4   |
| G (Green)       | 1   | 2   | 2   |
| B (Blue)        | 1   | 2   | 2   |
| P (Pure white)  | 1   | 2   | 2   |

LED chip



LED: 1



LED: 2



LED: 4

# PILOT LAMP & INDICATOR

## STANDARD PRODUCTS

### TMPN (φ 10)

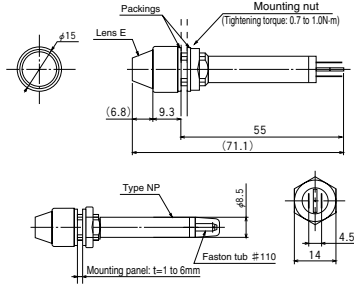

#### ●Applicable accessories

LED lamp **TMP-LEDN-□**

Lens **TMP Lens E-□**  
(Round flat type)  
**WMP Lens S-□**  
(Round type)

Tightening tool **TMP-Q**

#### ●Mounting hole size

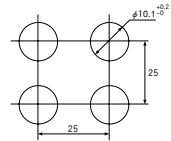

### TMPH (φ 10)

#### High-brightness type

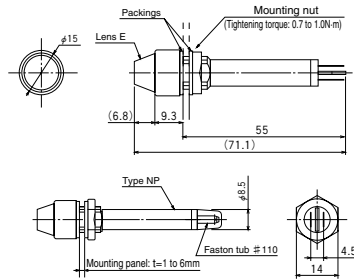

#### ●Applicable accessories

LED lamp **TMP-LEDH-□**

Lens **TMP Lens E-□**  
(Round flat type)  
**WMP Lens S-□**  
(Round type)

Tightening tool **TMP-Q**

#### ●Mounting hole size

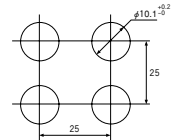

### TSPA (φ 16)

(GPT type is same shape)

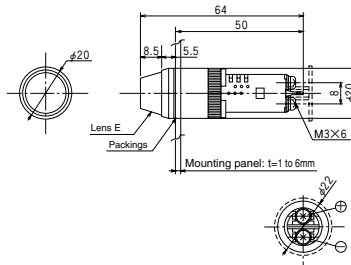

#### ●Applicable accessories

LED lamp **TS-LEDA-□**

Lens **TS-Lens E-□**  
(Round flat type)  
**WS-Lens S-□**  
(Round type)

Tightening tool **Tightening jig F**

Protective cover **TS-CV**

#### ●Mounting hole size

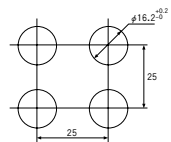



# ROUND TYPE LED INDICATOR

## STANDARD PRODUCTS

### HXL (φ 22)

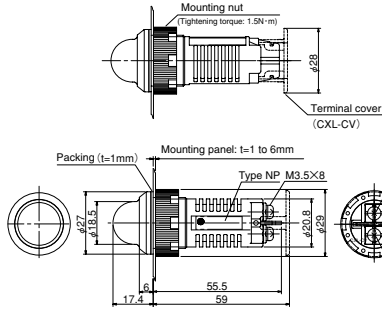

● Applicable accessories

|                 |               |
|-----------------|---------------|
| LED lamp        | HXL-LED□-□    |
| Lens            | HXL-LENS-□(S) |
| Tightening tool | CXL30-Q       |
| Removing tool   | XL-NQ         |
| Terminal cover  | CXL-CV        |

● Mounting hole

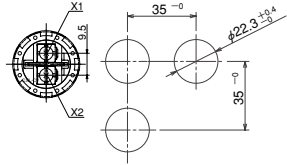

### JXL (φ 25)

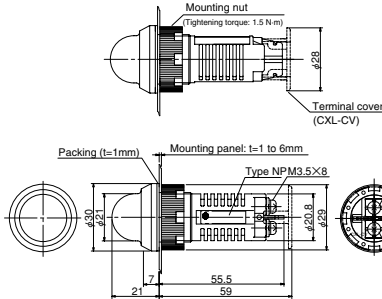

● Applicable accessories

|                 |               |
|-----------------|---------------|
| LED lamp        | PXL-LED□-□    |
| Lens            | JXL-LENS-□(S) |
| Tightening tool | CXL30-Q       |
| Removing tool   | XL-NQ         |
| Terminal cover  | CXL-CV        |

● Mounting hole

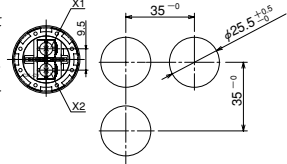

### PXL (φ 30)

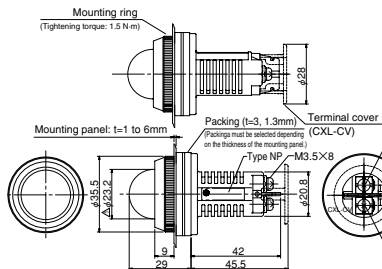

● Applicable accessories

|                |               |
|----------------|---------------|
| LED lamp       | PXL-LED□-□    |
| Lens           | PXL-LENS-□(S) |
| Removing tool  | XL-NQ         |
| Terminal cover | CXL-CV        |

● Mounting hole

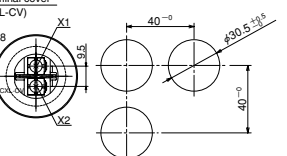

# PILOT LAMP & INDICATOR

---

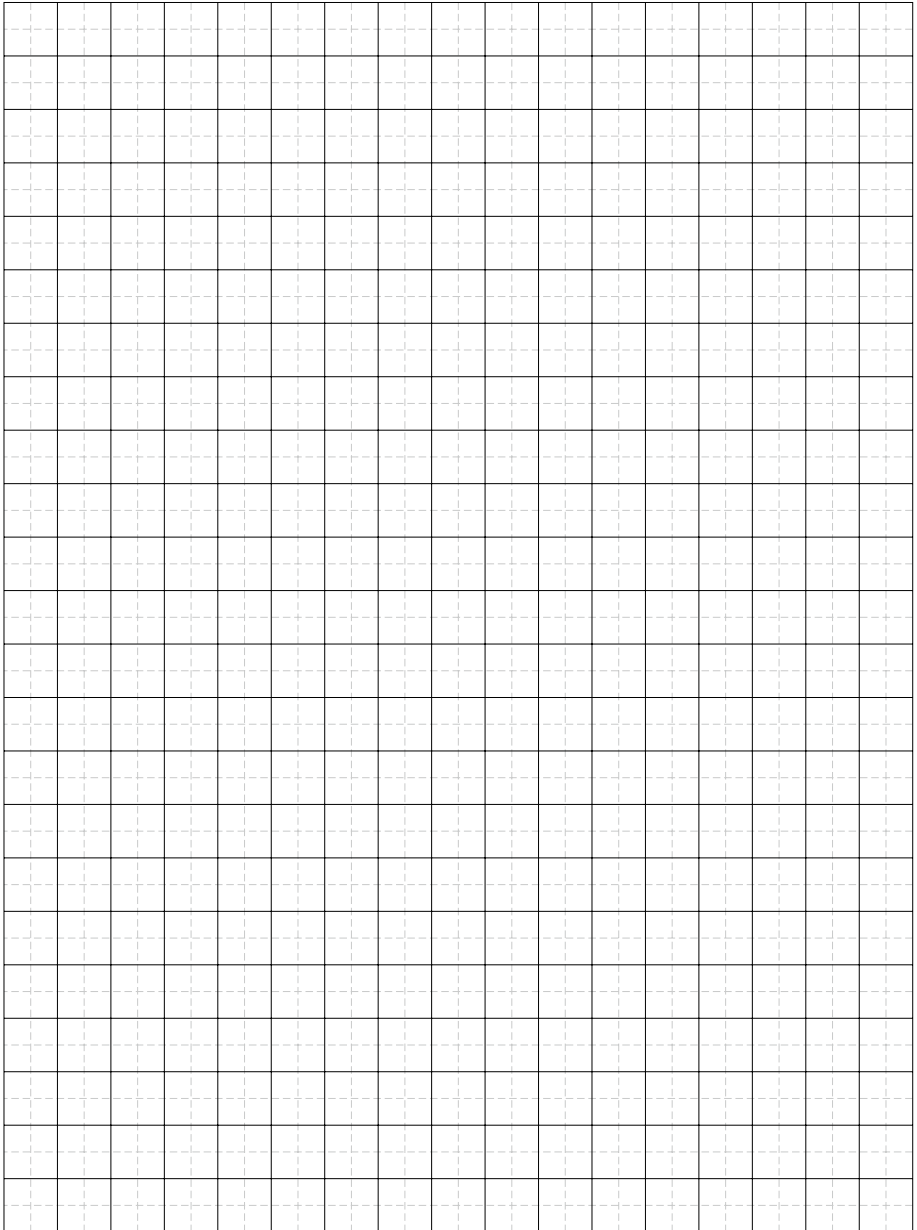

A SWITCH

**B** PILOT LAMP &  
INDICATOR

C CONNECTING  
DEVICES

D ELECTRONIC  
DEVICES

E CONTROL  
CENTER PARTS