

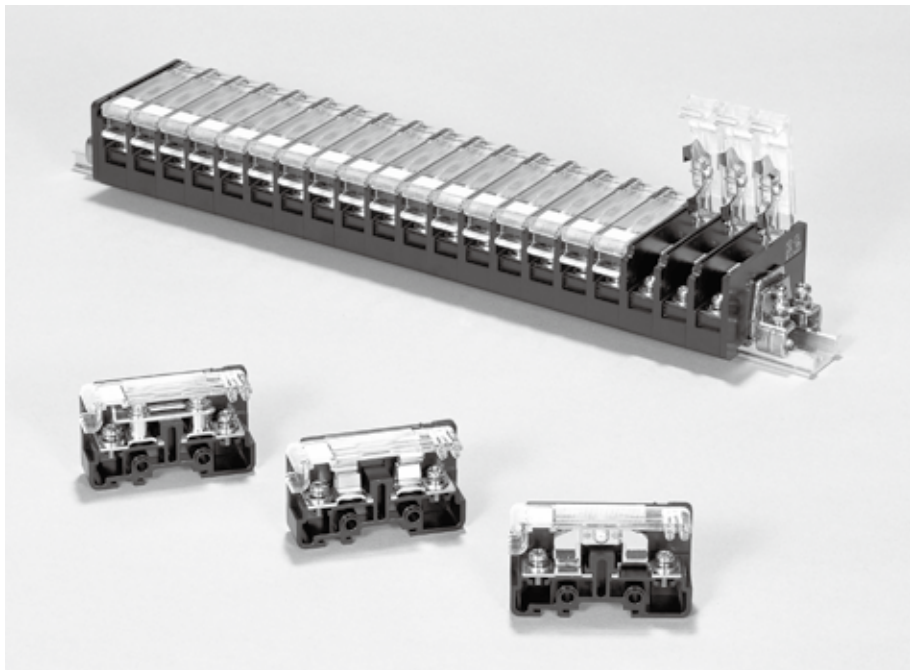

NS TYPE



FEATURES

- The circuit can be disconnected by pulling the lever.
- NS-15 can be assembled on the DIN rail, too. TUB rail and the shaft are also available.
- NS-F can be also used as a fuse stand.
- NS-TT enables disconnection and connection between the left and right banks with the internal short-circuit bar.
- NS-15 enables disconnection of 2 poles as a group.

SPECIFICATIONS (RATINGS, PERFORMANCE)

Specification	Type	NS-15	NS-F	NS-TT
Rated insulation voltage (U _i)		600V		250V
Rated current-carrying capacity (I _{th})		15A		
Max. wire size		5.5mm ²		
Screw size		M4×10		
Withstand voltage		2,500 V AC / 1 min.		
Lightning impulse		±7.2kV / 3 times for each pole (1.2 / 50 μs)		
Ambient operating temperature		-20 to 50°C		
Storing temperature		-40 to 75°C		
Altitude		2,000 m or less		

How to order

NS - 15 × 10 XF - 195

① ② ③ Assembly dimensions

No.	Item	Code	Detail	Remark	
①	Code	NS-15			
		NS-F		NS type disconnecting terminal block with fuse holder	
		NS-TT		NS type disconnecting terminal with short circuit function	
②	No. of poles	1 to max.	NS-15	1 to 36	Max. pole No. is less than 600mm of rail length. (In case over 600mm, max. pole No. is less than 1,000mm of reinforced rail (TKB-D).)
			NS-F	1 to 36	
			NS-TT	1 to 36	
③	Rail	XF	TXB-F rail type	U-cut rail (DIN rail)	(Recommended maximum length : 600mm)
		XD	TXB-D rail type	Punched rail (DIN rail)	(Recommended maximum length : 600mm)
		UF	TUB-F rail type	U-cut rail	(Recommended maximum length : 600mm)
		UD	TUB-D rail type	Punched rail	(Recommended maximum length : 600mm)
		KD	TKB-D rail type	Reinforced punched rail (DIN rail)	(Recommended maximum length : 1,000mm)
		(blank)			Not specified for shaft-mounting model only.

* For purchase of a single unit, specify ① only.

STANDARD PRODUCTS

NS-15 (15A)

Applicable wire size: 1.25 to 5.5 mm²

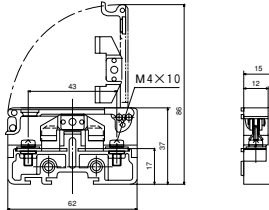
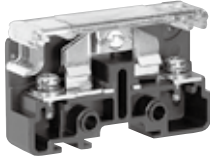

● Applicable accessories

End plate	NSE-15
Standard marker strip	TUM-1
Standard rail	TUB
End clamp	TUL-W

● Applicable crimp terminal

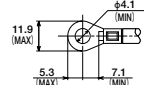

* With insulating cover

With fuse holder

NS-F (10A)

Applicable wire size: 1.25 to 5.5 mm²

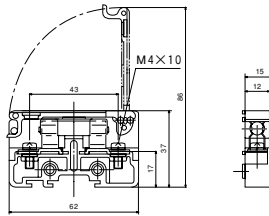
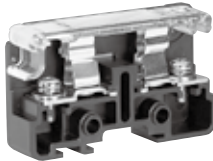

● Applicable accessories

End plate	NSE-F
Standard marker strip	TUM-1
Standard rail	TUB
End clamp	TUL-W
Applicable fuse	φ 6.4 × 30

● Applicable crimp terminal

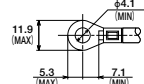

* With insulating cover

With short-circuit function

NS-TT (15A)

Applicable wire size: 1.25 to 5.5 mm²

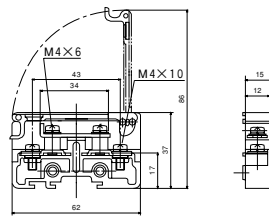
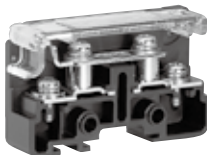

● Applicable accessories

End plate	NSE-TT
Standard marker strip	TUM-1
Standard rail	TUB
End clamp	TUL-W
Jumper	NS-TTS jumper

● Applicable crimp terminal

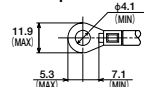

* With insulating cover



NS TYPE

TABLE OF ASSEMBLED DIMENSIONS

NS type assembly on punched rail

TUB-D type

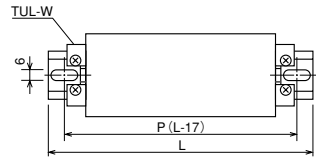

NS-15,F,TT

Pole	1	2	3	4	5	6	7	8	9	10	11	12	13	14	15
P	60		80	100	120	140		160	180		200	220	240	260	
L	77		97	117	137	157		177	197		217	237	257	277	
Rail	UD-4		UD-5	UD-6	UD-7	UD-8		UD-9	UD-10		UD-11	UD-12	UD-13	UD-14	
Pole	16	17	18	19	20	21	22	23	24	25	26	27	28	29	30
P	280	300	320		340	360	380		400	420	440		460	480	500
L	297	317	337		357	377	397		417	437	457		477	497	517
Rail	UD-15	UD-16	UD-17		UD-18	UD-19	UD-20		UD-21	UD-22	UD-23		UD-24	UD-25	UD-26

NS type assembly on U-cut rail

TUB-F type

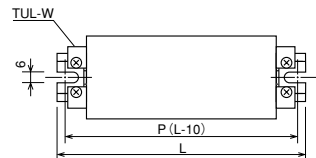

NS-15,F,TT

Pole	1	2	3	4	5	6	7	8	9	10	11	12	13	14	15
P	55	70	85	100	115	130	145	160	175	190	205	220	235	250	265
L	65	80	95	110	125	140	155	170	185	200	215	230	245	260	275
Rail	UF-65	UF-80	UF-95	UF-110	UF-125	UF-140	UF-155	UF-170	UF-185	UF-200	UF-215	UF-230	UF-245	UF-260	UF-275
Pole	16	17	18	19	20	21	22	23	24	25	26	27	28	29	30
P	280	295	310	325	340	350	370	385	400	415	430	445	460	475	490
L	290	305	320	335	350	360	380	395	410	425	440	455	470	485	500
Rail	UF-290	UF-305	UF-320	UF-335	UF-350	UF-360	UF-380	UF-395	UF-410	UF-425	UF-440	UF-455	UF-470	UF-485	UF-500

NS type shaft

NS shaft type

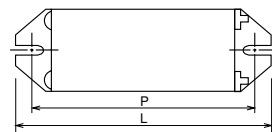

NS-15,F,TT

Pole	1	2	3	4	5	6	7	8	9	10	11	12
P	37	52	67	82	97	112	127	142	157	172	187	202
L	47	62	77	92	107	122	137	152	167	182	197	212

NS type assembly on punched rail

TXB-D type

NS-15,F,TT

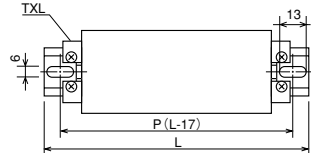

Pole	1	2	3	4	5	6	7	8	9	10	11	12	13	14	15							
P	60		80		100		120		140		160		180		200		220		240		260	
L	77		97		117		137		157		177		197		217		237		257		277	
Rail	XD-4		XD-5		XD-6		XD-7		XD-8		XD-9		XD-10		XD-11		XD-12		XD-13		XD-14	
Pole	16	17	18	19	20	21	22	23	24	25	26	27	28	29	30							
P	280		300		320		340		360		380		400		420		440		460		480	
L	297		317		337		357		377		397		417		437		457		477		497	
Rail	XD-15		XD-16		XD-17		XD-18		XD-19		XD-20		XD-21		XD-22		XD-23		XD-24		XD-25	

NS type assembly on U-cut rail

TXB-F type

NS-15,F,TT

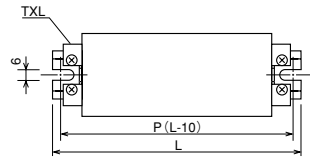

Pole	1	2	3	4	5	6	7	8	9	10	11	12	13	14	15
P	50	65	80	95	110	125	140	155	170	185	200	215	230	245	260
L	60	75	90	105	120	135	150	165	180	195	210	225	240	255	270
Rail	XF-60	XF-75	XF-90	XF-105	XF-120	XF-135	XF-150	XF-165	XF-180	XF-195	XF-210	XF-225	XF-240	XF-255	XF-270
Pole	16	17	18	19	20	21	22	23	24	25	26	27	28	29	30
P	275	290	305	320	335	350	365	380	395	410	425	440	455	470	485
L	285	300	315	330	345	360	375	390	405	420	435	450	465	480	495
Rail	XF-285	XF-300	XF-315	XF-330	XF-345	XF-360	XF-375	XF-390	XF-405	XF-420	XF-435	XF-450	XF-465	XF-480	XF-495

ACCESSORIES

Please see page C127 to C130 for accessories.