

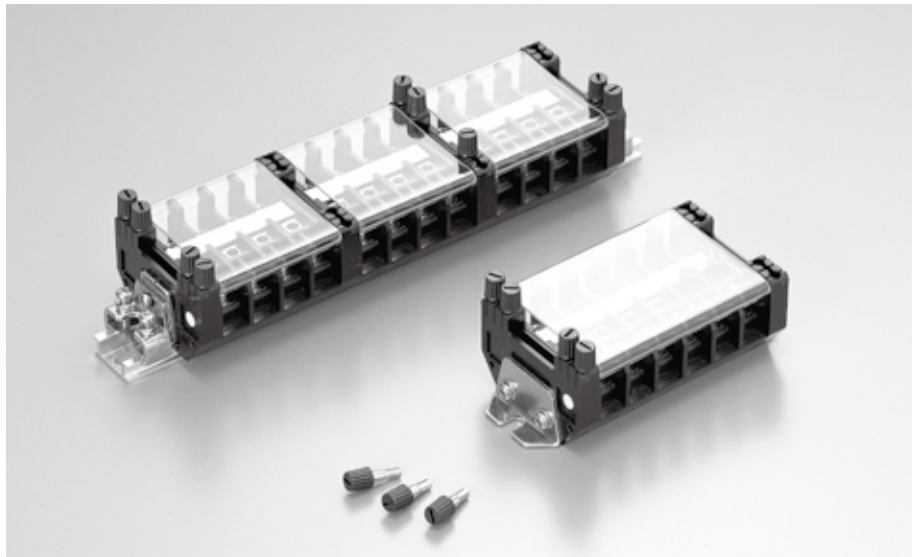

TERMINAL BLOCK WITH SHORT CIRCUIT

TU-ST TYPE



FEATURES

- TU-ST series is a terminal block which can short circuit by insertion of short bolts.
- Short of CT circuit and change the tap position can be done freely.
- The short bolt can be attached to the end plate for preventing loss of bolts.

SPECIFICATIONS

Specification	Type	TU-ST
Rated insulation voltage (Ui)		600V
Rated current-carrying capacity (Ith)		40A
Max. wire size		14mm ²
Screw size		M5×10 (SUS)
Withstand voltage		2,500 V AC / 1 min.
Lightning impulse		±8kV / 5 times for each pole (1.2 / 50 μs)
Ambient operating temperature		-25 to 50°C
Storing temperature		-40 to 85°C
Altitude		2,000 m or less

How to order of terminal blocks

The TU-ST type is sold only as assembly.

TU-ST-^{*}6 × 4 UD - 22 ● Short bolts are selling separately.

① ② ③ ④ Assembly dimensions

No.	Item	Code	Detail	Remark
①	Basic type	TU-ST	TU-ST Terminal block with short circuit	—
②	No. of poles	2~9	Number of poles in 1 group	—
③	No. of groups	1~5	Number of groups in unit block	Refer to the table of assembled dimensions.
		UD	TUB-D type rail	Punched rail (Recommended maximum length: 600mm)
④	Rail	UF	TUB-F type rail	U-cut rail (Recommended maximum length: 600mm)
		—	Shaft assembly	(Recommended maximum length of shaft: 380mm)

STANDARD PRODUCTS

TU-ST (40A)

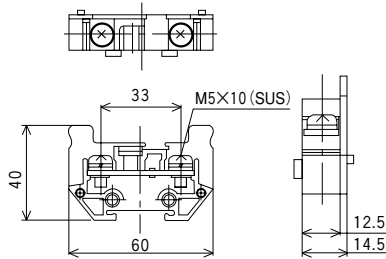

● Applicable accessories

End plate	TUE-ST
Standard marker strip	TUM-2
Standard rail	TUB
End clamp	TUL-W
Cover	TUC-15
Short bolt	TU-ST S bolt

● Applicable crimp terminal

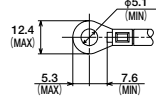

* With insulating cover

TABLE OF ASSEMBLED DIMENSIONS

● Shaft assembly

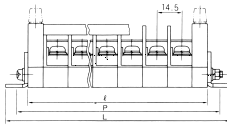

● Shaft assembly

Dimensions	Pole	2	3	4	5	6	7	8	9
ℓ		47	61.5	76	90.5	105	119.5	134	148.5
P		62	76.5	91	105.5	120	134.5	149	163.5
L		73	88	102	117	131	146	160	175

P = L-11

● Rail assembly (DIN rail)

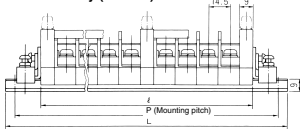

● UF rail assembly

Number of groups	Pole	2	3	4	5	6	7	8	9
1	L=90	105	120	135	150	165	180	195	
2		130	160	190	215	245	275	305	335
3		170	210	255	300	340	385	430	475
4		205	265	320	380	440	495	555	
5		245	315	390	460	535			

P = L-10

● UD rail assembly

Number of groups	Pole	2	3	4	5	6	7	8	9
1	L=97	117	137	137	157	177	177	197	
2		137	157	197	217	257	277	317	337
3		177	217	257	297	357	397	437	477
4		217	277	337	377	437	497	557	
5		257	317	397	477	537			

P = L-17

CIRCUIT DIAGRAM

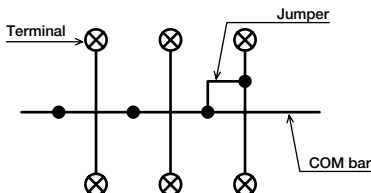



TERMINAL BLOCK WITH SHORT CIRCUIT

TU-ST TYPE

ACCESSORIES

End plate

(Order unit: 100)

●TUE-ST

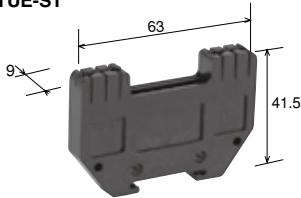

Short bolt

(Order unit: 100)

●TU-ST S bolt

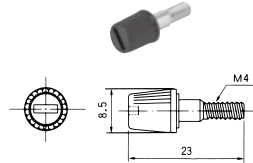

Marker strip

(Order unit: 100)

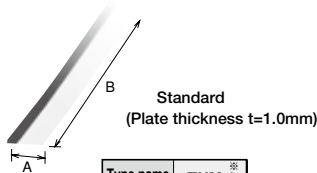

Type name	TUM-2*
A	10
B	900

* Plate thickness = 0.5 mm type is available.

Cover

(Order unit: 20)



Type name	TUC-15
A	62
B	1,000
C	7.5

End clamp

(Order unit: 50)

●TUL-W (for TUB)

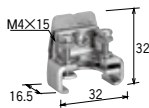

Aluminum rail

(Order unit: 50)

●TUB

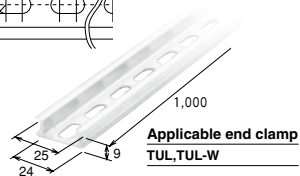
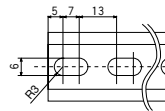

CONNECTING DEVICES

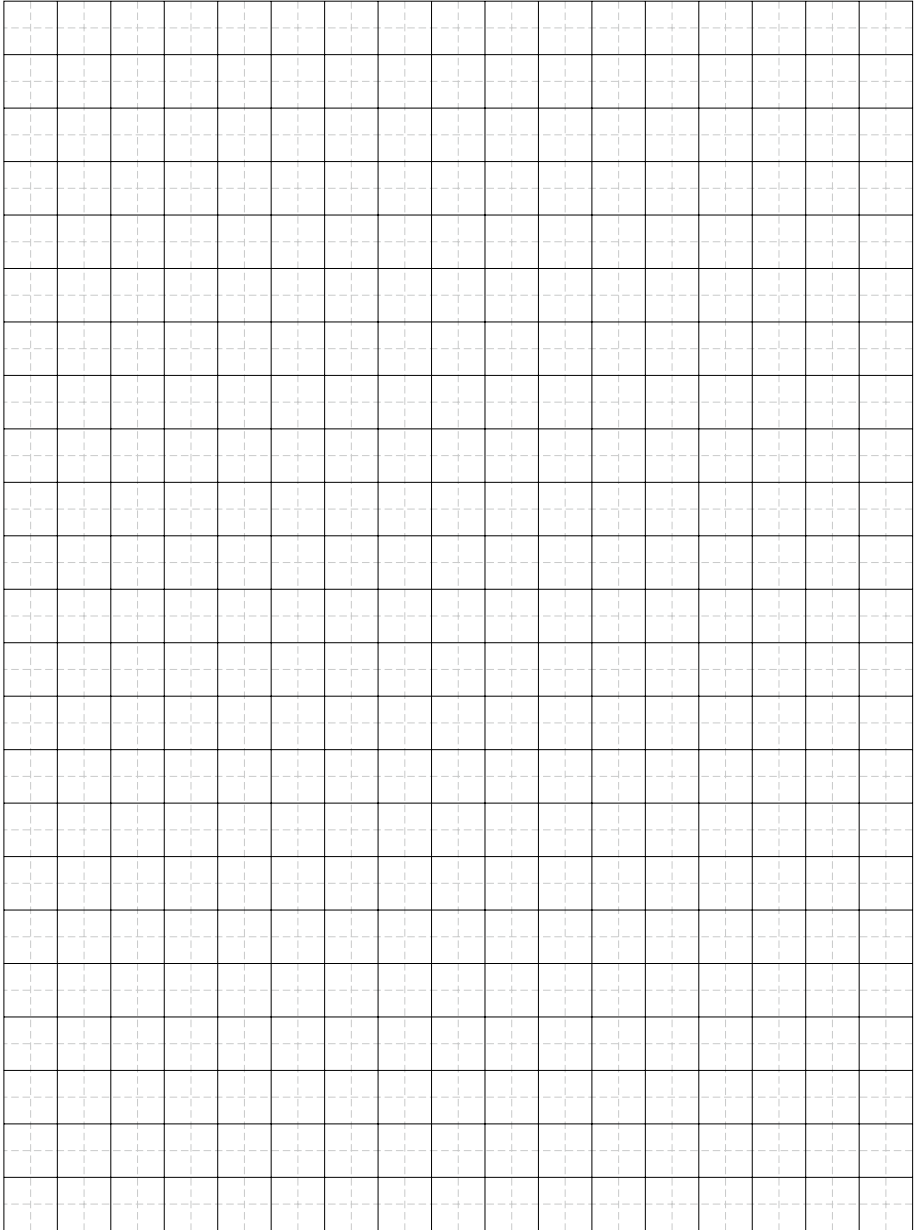

A SWITCH

B PILOT LAMP &
INDICATOR

C CONNECTING
DEVICES

D ELECTRONIC
DEVICES

E CONTROL
CENTER PARTS