

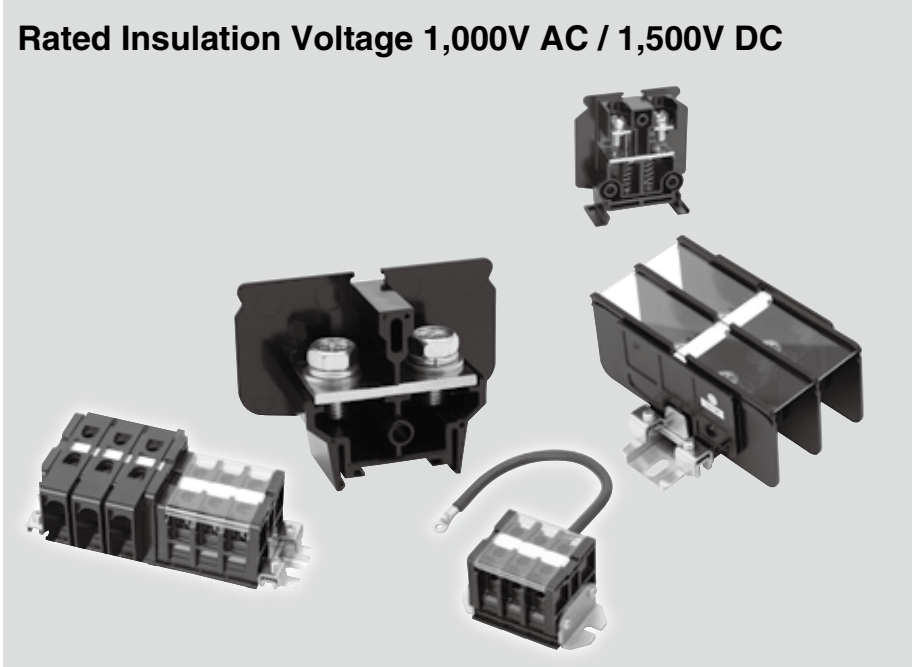

TXH TYPE

Rated Insulation Voltage 1,000V AC / 1,500V DC



FEATURES

High insulation voltage

Rated insulation voltage is 1,000V AC / 1,500V DC, and power-frequency withstand voltage is 5,000V AC / 1 min. (IEC60947)

High performance resin material

High performance modified-PPE is used as modeling resin material. Flame resistance is UL94 V-0 grade, comparative tracking index (CTI) is more than 600.

Easy mount and dismount

Terminal block can be mounted and dismounted from the rail unit by unit without removing end clamp.



Finger protection

Finger protection structure on terminal-portion prevents touching live portion even if terminal cover is not attached.



Wire cover

Insulation distance can be kept without insulation cap by attaching a wire cover.



* Please make insulation protection applicable to equipment and voltage.

* Wire cover (TXH-□-CV) is not included in terminal block order.

SPECIFICATIONS (RATINGS, PERFORMANCE, STANDARD OPERATING CONDITION)

Applicable standard: IEC 60947-7-1(2009)

Item		TXH-5.5	TXH-14	TXH-38F	TXH-60F
Rating	Rated insulation voltage (Ui)	1,000V AC / 1,500V DC			
	Rated current-carrying capacity (Ith)	30A	60A	132A	175A
	Applicable wire size	2.0 to 5.5mm ²	5.5 to 14mm ²	14~38mm ²	38~60mm ²
	Screw size	M4x8.5	M5x11	M8x16	
Performance	Power-frequency withstand voltage	5,000V AC / 1 min.			
	Impulse withstand voltage	12 kV			
	Short-time withstand current	120A / 1 min. per 1 mm ²			
Standard operating condition	Ambient operating temperature	-25 to 50°C			
	Relative humidity	45 to 85°C			
	Altitude	2,000 m or less			

How to order

TXH-5.5 R S C × 10-XF-200

① ② ③ ④ ⑤ ⑥ Assembly dimensions

No.	Item	Code	Detail
①	Basic type	TXH-5.5	—
		TXH-14	—
		TXH-38F	—
		TXH-60F	—
②	Color	(blank)	Black
		R*1,*2	Red
③	Screw type	(blank)	Iron screw
		S*2	Stainless steel screw
④	Wire cover	(blank)	—
		C*2	With wire cover
⑤	No. of poles	1 to max.*3	For further details, please see page C53 to C54 for assembled dimensions.
⑥	Rail	XD	TXB-D rail type : Punched rail (DIN rail)
		XF	TXB-F rail type : U-cut rail (DIN rail)
		KD*2	TKB-D rail type : Reinforced punched rail (DIN rail)
		S*2	Shaft assembly

*1 Special color

*2 Corresponding only TXH-5.5 and 14.

*3 Max. pole No. is less than 600mm of rail length.
(In case over 600mm, max. pole No. is less than 1,000mm of reinforced rail (TKB-D).)



TXH TYPE

STANDARD PRODUCTS

TXH-5.5

Applicable wire size: 2 to 5.5 mm²

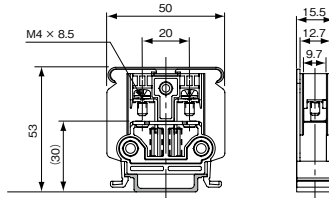

●Applicable accessories

End plate	TXHE-5.5
Standard marker strip	TUM-2
Standard rail	TXB
End clamp	TXL
Cover	TUC-8

●Applicable crimp terminal

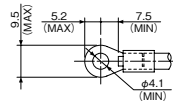

●With wire cover (TXH-CV)

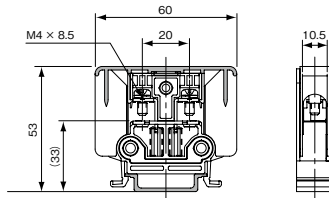

TXH-14

Applicable wire size: 5.5 to 14 mm²

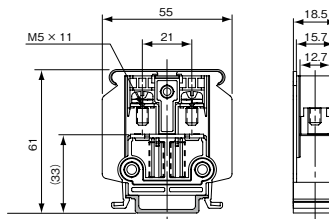

●Applicable accessories

End plate	TXHE-14
Standard marker strip	TUM-2
Standard rail	TXB
End clamp	TXL
Cover	TUC-8

●Applicable crimp terminal

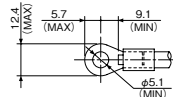

●With wire cover (TXH-CV)

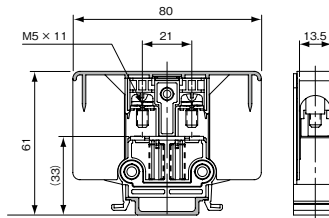

TXH-38F

Applicable wire size: 14 to 38 mm²

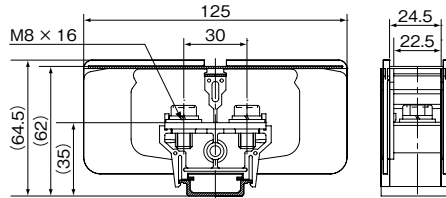

●Applicable accessories

Unit	TX-38F
End plate	TXE-38
Standard marker strip	TUM-2
Standard rail	TXB
End clamp	TXL
Cover	With TXHC-38F
Separator	With TXH-38F separator (2pcs)*

*Number of units + 1 pcs of cover is required.

●Applicable crimp terminal

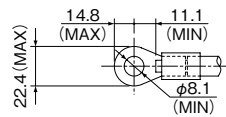

TXH-60F

Applicable wire size: 38 to 60 mm²

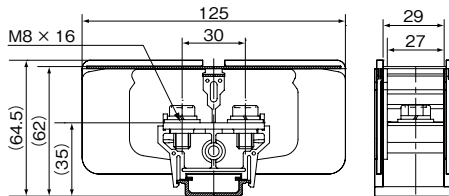

●Applicable accessories

Unit	TX-60F
End plate	TXE-38
Standard marker strip	TUM-2
Standard rail	TXB
End clamp	TXL
Cover	With TXHC-60F
Separator	With TXH-38F separator (2pcs)*

*Number of units + 1 pcs of cover is required.

●Applicable crimp terminal

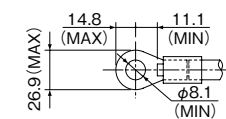



TXH TYPE

TABLE OF ASSEMBLED DIMENSIONS

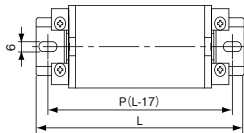

TXB-D or TKB-D type

Pole	TXH-5.5		
	P	L	Rail
1	60	77	XD-KD-4
2	60	77	XD-KD-4
3	80	97	XD-KD-5
4	100	117	XD-KD-6
5	120	137	XD-KD-7
6	140	157	XD-KD-8
7	140	157	XD-KD-8
8	160	177	XD-KD-9
9	180	197	XD-KD-10
10	200	217	XD-KD-11
11	200	217	XD-KD-11
12	220	237	XD-KD-12
13	240	257	XD-KD-13
14	260	277	XD-KD-14
15	280	297	XD-KD-15
16	280	297	XD-KD-15
17	300	317	XD-KD-16
18	320	337	XD-KD-17
19	340	357	XD-KD-18
20	340	357	XD-KD-18
21	360	377	XD-KD-19
22	380	397	XD-KD-20
23	400	417	XD-KD-21
24	400	417	XD-KD-21
25	420	437	XD-KD-22
26	440	457	XD-KD-23
27	460	477	XD-KD-24
28	480	497	XD-KD-25
29	480	497	XD-KD-25
30	500	517	XD-KD-26
31	520	537	XD-KD-27
32	540	557	XD-KD-28
33	540	557	XD-KD-28
34	560	577	XD-KD-29
35	580	597	XD-KD-30
36	600	617	KD-31
37	620	637	KD-32
38	620	637	KD-32
39	640	657	KD-33
40	660	677	KD-34
41	680	697	KD-35
42	680	697	KD-35
43	700	717	KD-36
44	720	737	KD-37
45	740	757	KD-38
46	760	777	KD-39
47	760	777	KD-39
48	780	797	KD-40
49	800	817	KD-41
50	820	837	KD-42
51	820	837	KD-42
52	840	857	KD-43
53	860	877	KD-44
54	880	897	KD-45
55	900	917	KD-46
56	900	917	KD-46
57	920	937	KD-47
58	940	957	KD-48
59	960	977	KD-49
60	960	977	KD-49
61	980	997	KD-50

Pole	TXH-14		
	P	L	Rail
1	60	77	XD-KD-4
2	80	97	XD-KD-5
3	100	117	XD-KD-6
4	120	137	XD-KD-7
5	140	157	XD-KD-8
6	140	157	XD-KD-8
7	160	177	XD-KD-9
8	180	197	XD-KD-10
9	200	217	XD-KD-11
10	220	237	XD-KD-12
11	240	257	XD-KD-13
12	260	277	XD-KD-14
13	280	297	XD-KD-15
14	300	317	XD-KD-16
15	320	337	XD-KD-17
16	340	357	XD-KD-18
17	360	377	XD-KD-19
18	380	397	XD-KD-20
19	380	397	XD-KD-20
20	400	417	XD-KD-21
21	420	437	XD-KD-22
22	440	457	XD-KD-23
23	460	477	XD-KD-24
24	480	497	XD-KD-25
25	500	517	XD-KD-26
26	520	537	XD-KD-27
27	540	557	XD-KD-28
28	560	577	XD-KD-29
29	580	597	XD-KD-30
30	600	617	KD-31
31	620	637	KD-32
32	620	637	KD-32
33	640	657	KD-33
34	660	677	KD-34
35	680	697	KD-35
36	700	717	KD-36
37	720	737	KD-37
38	740	757	KD-38
39	760	777	KD-39
40	780	797	KD-40
41	800	817	KD-41
42	820	837	KD-42
43	840	857	KD-43
44	860	877	KD-44
45	880	897	KD-45
46	880	897	KD-45
47	900	917	KD-46
48	920	937	KD-47
49	940	957	KD-48
50	960	977	KD-49
51	980	997	KD-50

Pole	TXH-38F		
	P	L	Rail
1	60	77	XD-4
2	100	117	XD-6
3	120	137	XD-7
4	160	177	XD-9
5	180	197	XD-10
6	200	217	XD-11
7	240	257	XD-13
8	260	277	XD-14
9	300	317	XD-16
10	320	337	XD-17
11	360	377	XD-19
12	380	397	XD-20
13	400	417	XD-21
14	440	457	XD-23
15	460	477	XD-24
16	500	517	XD-26
17	520	537	XD-27
18	560	577	XD-29
19	580	597	XD-30

Pole	TXH-60F		
	P	L	Rail
1	80	97	XD-5
2	100	117	XD-6
3	140	157	XD-8
4	160	177	XD-9
5	200	217	XD-11
6	240	257	XD-13
7	260	277	XD-14
8	300	317	XD-16
9	340	357	XD-18
10	360	377	XD-19
11	400	417	XD-21
12	440	457	XD-23
13	460	477	XD-24
14	500	517	XD-26
15	540	557	XD-28
16	560	577	XD-29

* Rail designation is XD-[pole] for standard rail TXB type.
 * Rail designation is KD-[pole] for reinforced rail TKB type.

CONNECTING DEVICES

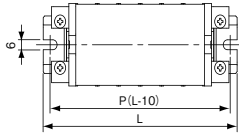

TXB-F type

Pole	TXH-5.5		
	P	L	Rail
1	55	65	XF-65
2	70	80	XF-80
3	85	95	XF-95
4	100	110	XF-110
5	115	125	XF-125
6	130	140	XF-140
7	145	155	XF-155
8	160	170	XF-170
9	175	185	XF-185
10	190	200	XF-200
11	210	220	XF-220
12	225	235	XF-235
13	240	250	XF-250
14	255	265	XF-265
15	270	280	XF-280
16	285	295	XF-295
17	300	310	XF-310
18	315	325	XF-325
19	330	340	XF-340
20	345	355	XF-355
21	365	375	XF-375
22	380	390	XF-390
23	395	405	XF-405
24	410	420	XF-420
25	425	435	XF-435
26	440	450	XF-450
27	455	465	XF-465
28	470	480	XF-480
29	485	495	XF-495
30	500	510	XF-510
31	520	530	XF-530
32	535	545	XF-545
33	550	560	XF-560
34	565	575	XF-575
35	580	590	XF-590

Pole	TXH-14		
	P	L	Rail
1	55	65	XF-65
2	75	85	XF-85
3	95	105	XF-105
4	110	120	XF-120
5	130	140	XF-140
6	150	160	XF-160
7	165	175	XF-175
8	185	195	XF-195
9	205	215	XF-215
10	220	230	XF-230
11	240	250	XF-250
12	260	270	XF-270
13	280	290	XF-290
14	295	305	XF-305
15	315	325	XF-325
16	335	345	XF-345
17	350	360	XF-360
18	370	380	XF-380
19	390	400	XF-400
20	405	415	XF-415
21	425	435	XF-435
22	445	455	XF-455
23	465	475	XF-475
24	480	490	XF-490
25	500	510	XF-510
26	520	530	XF-530
27	535	545	XF-545
28	555	565	XF-565
29	575	585	XF-585

Pole	TXH-38F		
	P	L	Rail
1	65	75	XF-75
2	95	105	XF-105
3	125	135	XF-135
4	150	160	XF-160
5	180	190	XF-190
6	210	220	XF-220
7	235	245	XF-245
8	265	275	XF-275
9	295	305	XF-305
10	320	330	XF-330
11	350	360	XF-360
12	380	390	XF-390
13	410	420	XF-420
14	435	445	XF-445
15	465	475	XF-475
16	495	505	XF-505
17	520	530	XF-530
18	550	560	XF-560
19	580	590	XF-590

Pole	TXH-60F		
	P	L	Rail
1	70	80	XF-80
2	105	115	XF-115
3	135	145	XF-145
4	170	180	XF-180
5	200	210	XF-210
6	235	245	XF-245
7	270	280	XF-280
8	300	310	XF-310
9	335	345	XF-345
10	365	375	XF-375
11	400	410	XF-410
12	435	445	XF-445
13	465	475	XF-475
14	500	510	XF-510
15	530	540	XF-540
16	565	575	XF-575

* Rail designation is XD-pole for standard rail TXB type.

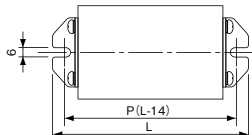

Shaft assembly

Pole	TXH-5.5	
	P	L
1	41.5	55.5
2	57	71
3	72.5	86.5
4	88	102
5	103.5	117.5
6	119	133
7	134.5	148.5
8	150	164
9	165.5	179.5
10	181	195
11	196.5	210.5
12	212	226
13	227.5	241.5
14	243	257
15	258.5	272.5
16	274	288
17	289.5	303.5
18	305	319
19	320.5	334.5
20	336	350
21	351.5	365.5

Pole	TXH-14	
	P	L
1	44.5	58.5
2	63	77
3	81.5	95.5
4	100	114
5	118.5	132.5
6	137	151
7	155.5	169.5
8	174	188
9	192.5	206.5
10	211	225
11	229.5	243.5
12	248	262
13	266.5	280.5
14	285	299
15	303.5	317.5
16	322	336
17	340.5	354.5
18	359	373
19	377.5	391.5



TXH TYPE

Product Composition

How to order for a single component (TXH-5.5, 14)

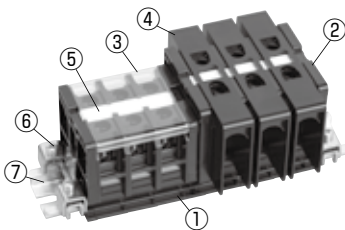

- ① Unit part
- ② End plate
- ③ Cover (Standard length: 1,000 mm)
- ④ Wire cover
- ⑤ Marker strip (Standard length: 900 mm)
- ⑥ End clamp
- ⑦ Rail (Standard length: 1,000 mm)

Check with the list of accessories (C56) to place an order with the applicable types.

How to order for a single component (TXH-38F, 60F)

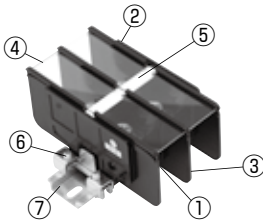

- ① Unit part
- ② End plate
- ③ Separator
- ④ Cover
- ⑤ Marker strip (Standard length: 900 mm)
- ⑥ End clamp
- ⑦ Rail (Standard length: 1,000 mm)

Check with the list of accessories (C56) to place an order with the applicable types.

Caution

Precautions for use

- Please use the products within the range of ratings indicated.
- Misconnection leads to an accident, so please make sure the connection is sufficient.
- Before using, be sure to check that there is no abnormality such as wire breakage.
- Avoid specifications under abnormal circumstances such as high temperature, high humidity, dust, corrosive gas, vibration shock and so on.
- When considering for the special applications, please thoroughly examine beforehand.
- Please use the products in the state of not applying organic solvents, grease etc.
- Please do not apply mechanical stress such as pulling to the terminal block.
- Please apply insulation protection suitable for your equipment and voltage to crimp terminal. (TXH-□-CV is prepared as insulation protection.)



TXH TYPE

ACCESSORIES

End clamp

●TXL

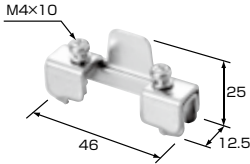

Aluminium rail (DIN)

●TXB (standard)

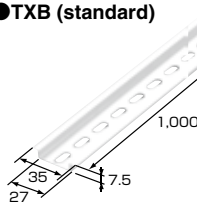

●TKB (reinforced)

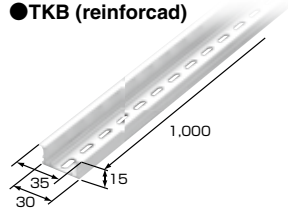

Wire cover

●TXH-□-CV

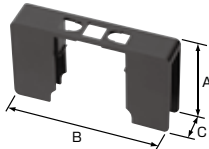

Basic type	TXH-5.5-CV	TXH-14-CV
A	38	46
B	60	80
C	12.5	15.5

Terminal cover

●TUC-8 (for terminal)

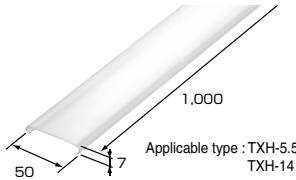

Cover

●TXHC

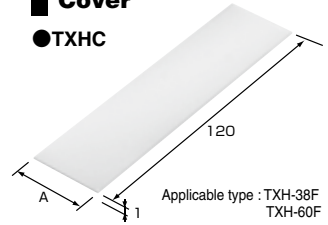

Basic type	TXHC-38F	TXHC-60F
A	27.5	32

End plate

●TXHE / TXE

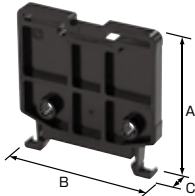

Basic type	TXHE-5.5	TXHE-14	TXE-38
A	51	59	57
B	50	55	80
C	5	5	3

* Please use TXE-38 for the end plate of TXH-60F.

Separator

●TXH-38F Separator

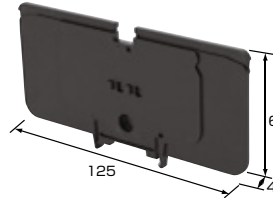

* Number of units + 1 pcs of separator is required.
* Please use TXH-38F separator for the separator of TXH-60F.

Marker strip

●TUM-2

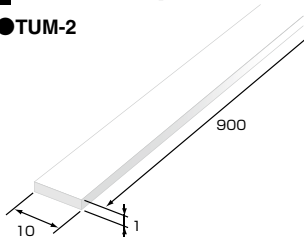

How to remove marker strip

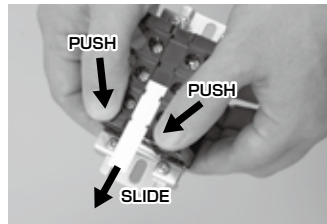

Marker strip is easily removed by pushing end the plate.

Rail cap

Please refer to the page C15 for the rail cap.