



M25N TYPE



FEATURES

■ Applicable standards

JIS C8151 Indicators for Industrial Use, JIS C4521 Button Switches for Control Use, JIS C4520 General Rules for Control Switches, and JEM1248 Indicators

■ Small and light-weight

This is an illuminated type compact pushbutton switch with an LED indicator. It has become much lighter than a transformer or resistor type switch with a incandescent lamp.

■ The lamp can be directly illuminated with power source of 110 / 220 V

■ Free of mislighting

Mislighting is prevented by inductive voltage.

■ Easy wiring work

The Faston connection method is used to enable rapid wiring work.

■ Energy and maintenance work saving

LEDs are used for energy saving and maintenance saving.

■ Cable release

The model with a cable release (T type) is useful for resetting the thermal relay in the control center or the like.

SPECIFICATIONS (RATINGS, PERFORMANCE)

| Specification | Type | M25N TYPE |
|---------------------------------------|---|--|
| Rated insulation voltage (Ui) | | 250V |
| Rated operating voltage (Ith) | | 24V, 110V AC / DC, 220V AC |
| Rated current-carrying capacity (Ith) | | AC: 11mA DC: 16mA |
| Rated withstand voltage | | 2,500V AC / 1 min. |
| Lighting impulse | Between live parts (L-L) Use part to assembly mounting panel (L-A) | ±3kV / 3 times for each pole (1.2 / 50µs) ±7kV / 3 times for each pole (1.2 / 50µs) |
| Operating temperature | | -20 to 40°C |
| Storing temperature | | -30 to 85°C |
| Heat resistance | | Allowed to stand at 75°C for 24 hours |
| Recognizable distance | | Illuminance on mounting panel at distance of 10m: 1,000 LX |
| Panel thickness | | 1 to 3.2mm |
| Shock resistance | | 500 m/s ² (6 directions) |
| Terminal connection | | Faston terminal #187 series: 0.5 to 2.27 mm ² |

SPECIFICATION AND PERFORMANCE OF MICROSWITCH

| | |
|-----------------------|---|
| Contact | 250V AC 15A (resistance load) |
| | 250V AC 10A (inductive load) |
| Contact pushing load | 3.9N |
| Mechanical life | 10,000,000 operations or more |
| Electrical life | 100,000 operations or more |
| Insulation resistance | 100MΩ or more (500V DC insulation testing set) |
| Withstand voltage | 1,000V AC / 1 min. (Between discontinuous terminals) |
| | 2,000V AC / 1 min (Between terminal and ground). |
| Wiring terminal | |

HOW TO ORDER

M25N-C-110-R-11-B

Basic type

Switch type

| Code | Color |
|------|---|
| C | Illuminated type pushbutton switch |
| P | pushbutton switch |
| T | Illuminated type pushbutton switch with release |

Lamp voltage

| Code | Voltage |
|--------|--------------------|
| 24 | 24V AC / DC |
| 110 | 100 / 110V AC / DC |
| 125 | 125V AC / DC |
| 220 | 200 / 220V AC |
| (none) | P type only |

Mounting ring

| Code | Color |
|------|-------|
| B | N1.5 |

Contact / release

| Code | Contact / release |
|------|-------------------------|
| 01 | No switch / 1 release |
| 10 | 1C contact / No release |
| 11 | 1C contact / 1 release |
| 20 | 2C contact / No release |

Lens and LED color, button color

| Switch type | C, T, P | | |
|-------------|-------------|-----------|--------------|
| Code | Lens color | LED color | Button color |
| R | Red | Red | Red |
| G | Green | Green | Green |
| Y | Yellow | Yellow | Yellow |
| O | Orange | Orange | Orange |
| W | Milky white | Yellow | White |
| C | Clear | Orange | - |
| B | - | - | Black |

ACCESSORIES

LED unit

TS-LEDN-R

| Code | Display color | LED color | Shape |
|------|---------------|-----------|-------|
| R | Red | R | |
| G | Green | G | |
| Y | Yellow | Y | |
| O | Orange | O | |
| W | Milky white | Y | |
| C | Clear | O | |

Applicable types: M25N-C

Lens

M25 lens R

| Code | Display color |
|------|---------------|
| R | Red |
| G | Green |
| Y | Yellow |
| O | Orange |
| W | Milky white |
| C | Clear |



Applicable types:
M25N-C

Button

M25 button R

| Code | Display color |
|------|---------------|
| R | Red |
| G | Green |
| O | Orange |
| B | Black |



Applicable types:
M25N-P

Lens remover

●XL-NQ





M25N TYPE

STANDARD PRODUCTS

Illuminated type pushbutton with 1C contact

M25N-C- Supplied voltage - Color -10-B

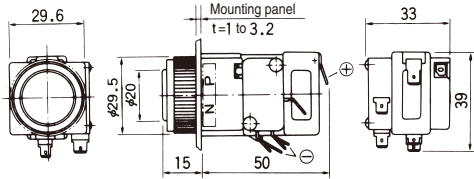

Illuminated type pushbutton with 2C contact

M25N-C- Supplied voltage - Color -20-B

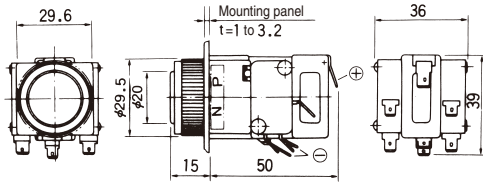

Illuminated type pushbutton with 1 release

M25N-T- Supplied voltage - Color -01-B

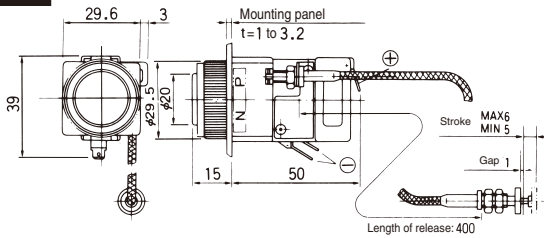

Illuminated type pushbutton with 1C contact and 1 release

M25N-T- Supplied voltage - Color -11-B

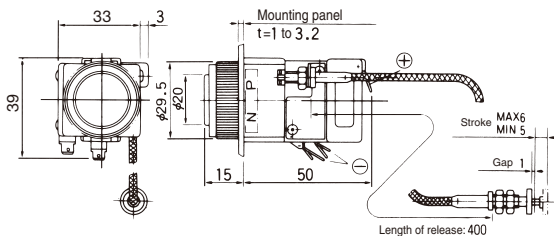
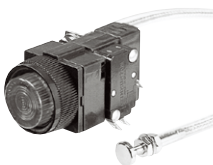

Pushbutton with 1C contact

M25N-P-Color-10-B

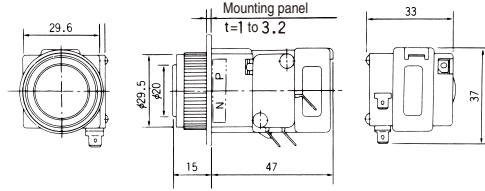

Pushbutton with 2C contact

M25N-P-Color-20-B

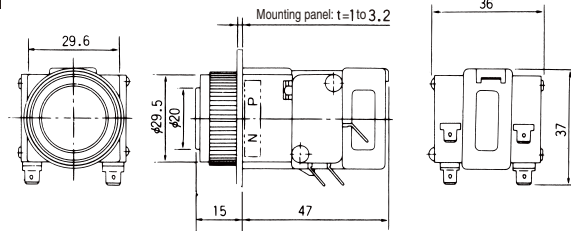

■ Min. mounting pitch

M25N
(1 release & 1C contact type)

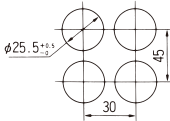

M25N
(2 release & 1C contact type and
1 release & 2C contact type)

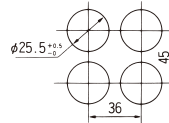

■ Handling the release

The release is bendable, but its stroke varies. It must be used over a circle with diameter of 50 mm.



■ Applicable receptacle (made by AMP) #187 series

| Type of receptacle | Applicable wire size | | Wire insulation cover size mm | Material and finish | Type of crimp tool | Instruction manual for crimp tool |
|--------------------|----------------------|-----------------|-------------------------------|------------------------------------|--------------------|-----------------------------------|
| | AWG | mm ² | | | | |
| 60711-1 | 24-20 | 0.2 to 0.56 | 1.02 to 1.78 | Brass + Tin plated | | |
| 170038-2 | 20-16 | 0.5 to 1.42 | 2.29 to 3.30 | Brass + Tin plated | 720590-1 | 013J |
| 170467-1 | 18-14 | 0.75 to 2.27 | 2.20 to 3.40 | Phosphorous bronze + Nickel plated | | |

Compatible types; M22N and M25N