



PRODUCTS RELATED TO CONTROL CENTER

PS TYPE RESET BUTTON

FEATURES

A reset button is available to reset the thermal relay of the magnet switch for the control center.

SPECIFICATIONS (RATINGS, PERFORMANCE)

Type	PS-THRY1	PS-THRY2
Rated insulation voltage (Ui)	600V	
Mechanical life	5,000,000 operations or more (Class 1)	
Operating temperature	-20 to 60°C	

HOW TO ORDER

PS-THRY 2B



Code	Button color	Code	Button color
B	Black	W	White
R	Red	O	Orange
G	Green	BG	Blue-green
Y	Yellow	YR	Brown

STANDARD PRODUCTS

PS-THRY1

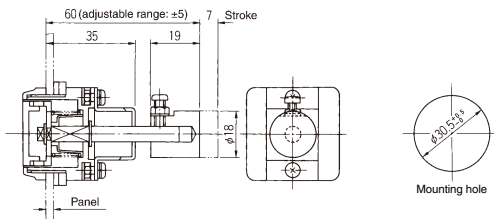

PS-THRY2

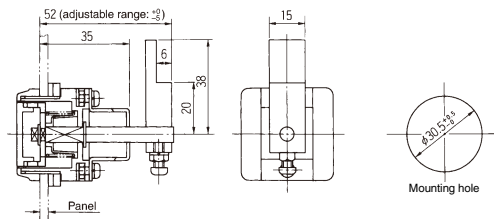

CONTROL CENTER PARTS