

# TQ TYPE

Terminal block with wire dropping-off prevention function

The wire dropping-off prevention function prevents improper wiring and saves time for wiring checks.

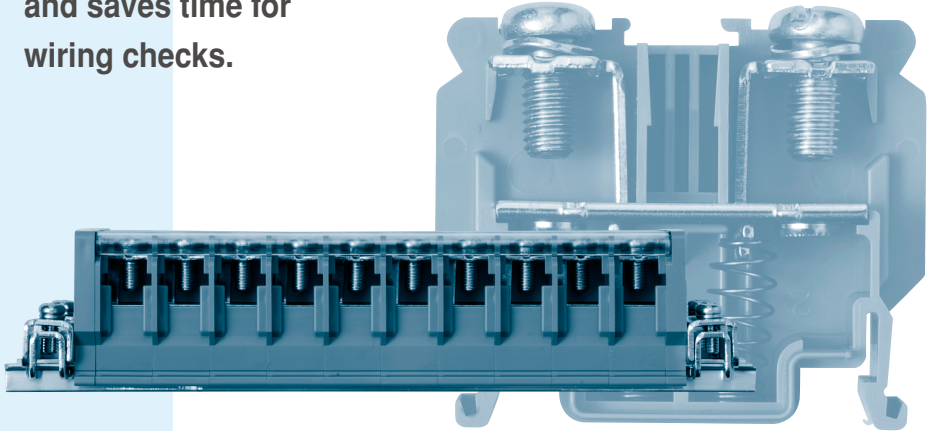

## FEATURES

### Wire dropping-off prevention structure

The wire dropping-off prevention function has been added to the conventional up-screw type terminal block. This function saves time for wiring checks.

The TQ type terminal blocks are available in three types (TQ-5.5, TQ-8 and TQ-14), covering cable sizes of 2 to 14 mm<sup>2</sup>.

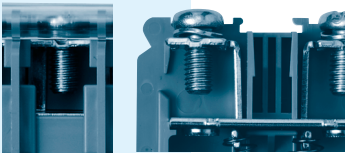

### Unit color differentiation

The terminal block is gray. It can be easily differentiated from conventional black terminal blocks.

\* The TQ type uses high-performance engineering plastic resin (modified PPE resin), the same material as conventional models.

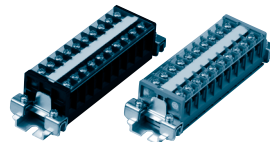

TJ Type

TQ Type

### Quick mounting to and dismounting from DIN rails

With the ribs on the sides of the terminal block, you can easily mount and dismount the terminal block for each pole.

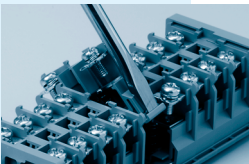

### Applicable to test tools

As with the conventional model (TJ type), the TQ type enables easy pressure voltage tests and sequence tests by using test tools.

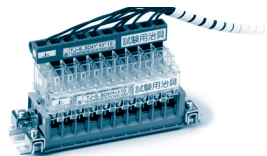

## Size reduction in comparison to the conventional model (TJ type)

The TQ-5.5 type is 1 mm lower than TJ-5.5, and the TQ-8, 14 types are lower than TJ-14, which enables more efficient use of available space.

## ● SPECIFICATIONS (RATING, PERFORMANCE / STANDARD OPERATING CONDITION)

Conformable standard: JIS C2811

Item		TQ-5.5	TQ-8	TQ-14
Rating	Rated insulation voltage (UI)	600V AC / DC		
	Rated impulse withstand voltage	6,000V		
	Rated current-carrying capacity (Ith)	30A	40A	60A
	Applicable wire size	2 to 5.5mm <sup>2</sup>	3.5 to 8mm <sup>2</sup>	5.5 to 14mm <sup>2</sup> *
Performance	Screw size	M4 x8.5	M5x11	
	Applicable crimp terminal	R2-4 / R3.5-4 / R5.5-4	R3.5-5 / R5.5-5 / R8-5	R5.5-5 / R8-5 / R14-5
	Power-frequency withstand voltage	2,500 V AC for 1 minute		
	Impulse withstand voltage	±7,200 V, three times for each pole (1.2 / 50 μs)		
Standard operating condition	Ambient temperature	-20 to +50°C		
	Storing temperature	-40 to +85°C		
	Altitude	2,000m max.		

\* The dropping-off prevention rib is effective for wires 8 mm<sup>2</sup> or larger in size.

## ● TYPE CODING

**TQ - 5.5**   **R × 36**   **XD**

①   ②   ③   ④

No.	Item	Code	Description	Remarks	
①	Basic type	TQ-5.5	5.5	Unit thickness: 11mm	
		TQ-8	8	Unit thickness: 14mm	
		TQ-14	14	Unit thickness: 14mm	
②	Unit color	None	Gray	Munsell approximate value: 7.5BG4 / 1.5	
		R	Red	Munsell approximate value: 7.5R4.5 / 14	
③	No. of units	1 to the maximum number	TQ-5.5	1 to 50	Maximum number of units depends on the number of units mounted on a rail of up to 600 mm. (If the mounting range exceeds 600 mm, it depends on the maximum number of units mounted on the TKB-D rail of up to 1,000 mm.)
			TQ-8	1 to 39	
			TQ-14	1 to 39	
④	Rail designation	XD	TXB-D rail	Punched rail (Recommended maximum length: 600mm)	
		XF	TXB-F rail	U-cut rail (Recommended maximum length: 600mm)	
		KD	TKB-D rail	Punched, reinforced rail (Recommended maximum length: 1,000mm)	

## STANDARD PRODUCTS

### TQ-5.5

Applicable wire  
: 2 to 5.5mm<sup>2</sup>

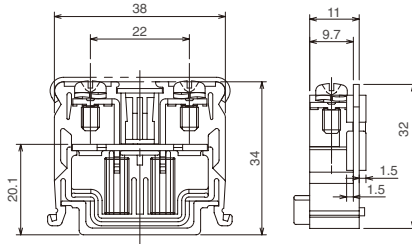
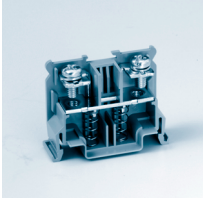

\* Red terminal type is also available. (TQ-5.5R)

#### ● Applicable crimp terminal

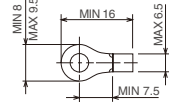

#### ● Accessories

End plate	TQE-5.5A / B
Standard marker strip	TUM-2 0.5T
Standard rail	TXB
End clamp	TXL
Cover	TUC-3

### TQ-8

Applicable wire  
: 3.5 to 8mm<sup>2</sup>

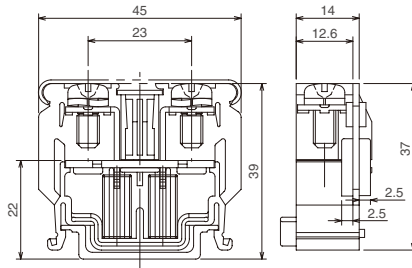
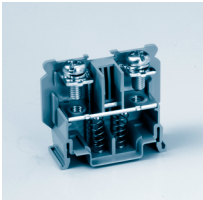

\* Red terminal type is also available. (TQ-8R)

#### ● Applicable crimp terminal

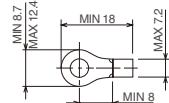

#### ● Accessories

End plate	TQE-8A / B
Standard marker strip	TUM-2 0.5T
Standard rail	TXB
End clamp	TXL
Cover	TUC-6

### TQ-14

Applicable wire  
: 5.5 to 14mm<sup>2</sup>

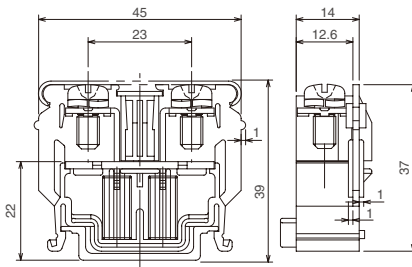
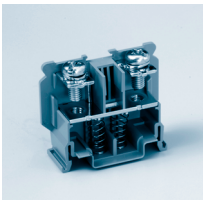

\* Red terminal type is also available. (TQ-14R)

#### ● Applicable crimp terminal

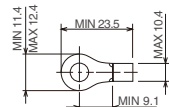

#### ● Accessories

End plate	TQE-14A / B
Standard marker strip	TUM-2 0.5T
Standard rail	TXB
End clamp	TXL
Cover	TUC-6

## ● DIMENSIONS (Combination)

### ■ TQ-5.5

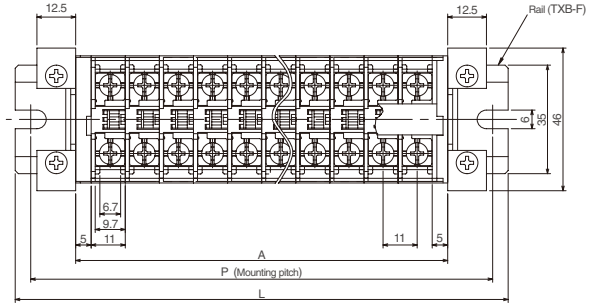
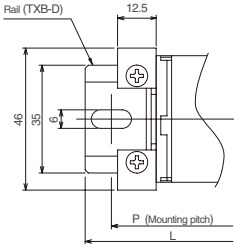

#### ● Assembly dimensions (Typical)

Number of units	1	5	10	15	20	
A	21	65	120	175	230	
TXB-F rail	P	50	90	145	200	255
L	60	100	155	210	265	
TXB-D rail	P	40	100	140	200	260
L	57	117	157	217	277	

Number of units	25	30	35	40	45	50	
A	285	340	395	450	505	560	
TXB-F rail	P	310	365	420	475	530	585
L	320	375	430	485	540	595	
TXB-D rail	P	320	360	420	480	540	580
L	337	377	437	497	557	597	

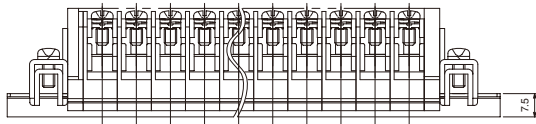

### ■ TQ-8, TQ-14

TQ-8 and TQ-14 are the same size (except for ribs).

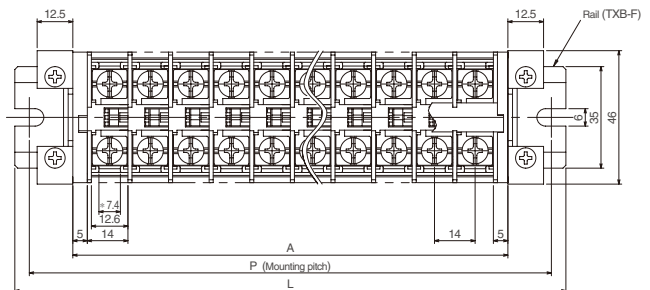
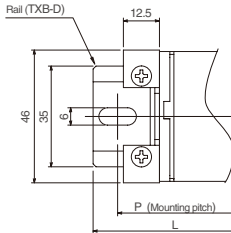

\* TQ-8: 7.4  
TQ-14: 10.6

#### ● Assembly dimensions (Typical)

Number of units	1	5	10	15	20	
A	24	80	150	220	290	
TXB-F rail	P	50	105	175	245	315
L	60	115	185	255	325	
TXB-D rail	P	60	100	180	240	320
L	77	117	197	257	337	

Number of units	25	30	35	39	
A	360	430	500	556	
TXB-F rail	P	385	455	525	585
L	395	465	535	595	
TXB-D rail	P	380	460	520	580
L	397	477	537	597	

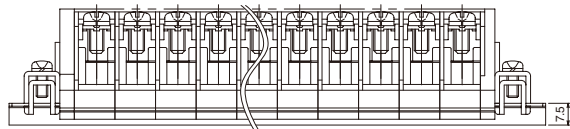

\* The above figure shows TQ-8 dimensions.

# TABLE OF ASSEMBLED DIMENSIONS

## Assembly on TXB-D type

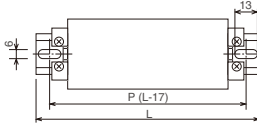

## Assembly on TXB-F type

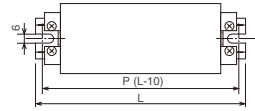







Type No. of units	TQ-5,5			TQ-8,14		
	P	L	Rail designation	P	L	Rail designation
1	40	57	XD-3	60	77	XD-4
2	60	77	XD-4	60	77	XD-4
3	80	97	XD-5	80	97	XD-5
4	80	97	XD-5	100	117	XD-6
5	100	117	XD-6	100	117	XD-6
6	100	117	XD-6	120	137	XD-7
7	120	137	XD-7	140	157	XD-8
8	120	137	XD-7	140	157	XD-8
9	140	157	XD-8	160	177	XD-9
10	140	157	XD-8	180	197	XD-10
11	160	177	XD-9	200	217	XD-11
12	160	177	XD-9	200	217	XD-11
13	180	197	XD-10	220	237	XD-12
14	200	217	XD-11	240	257	XD-13
15	200	217	XD-11	240	257	XD-13
16	220	237	XD-12	260	277	XD-14
17	220	237	XD-12	280	297	XD-15
18	240	257	XD-13	280	297	XD-15
19	240	257	XD-13	300	317	XD-16
20	260	277	XD-14	320	337	XD-17
21	260	277	XD-14	340	357	XD-18
22	280	297	XD-15	340	357	XD-18
23	300	317	XD-16	360	377	XD-19
24	300	317	XD-16	380	397	XD-20
25	320	337	XD-17	380	397	XD-20
26	320	337	XD-17	400	417	XD-21
27	340	357	XD-18	420	437	XD-22
28	340	357	XD-18	420	437	XD-22
29	360	377	XD-19	440	457	XD-23
30	360	377	XD-19	460	477	XD-24
31	380	397	XD-20	480	497	XD-25
32	380	397	XD-20	480	497	XD-25
33	400	417	XD-21	500	517	XD-26
34	420	437	XD-22	520	537	XD-27
35	420	437	XD-22	520	537	XD-27
36	440	457	XD-23	540	557	XD-28
37	440	457	XD-23	560	577	XD-29
38	460	477	XD-24	560	577	XD-29
39	460	477	XD-24	580	597	XD-30
40	480	497	XD-25			
41	480	497	XD-25			
42	500	517	XD-26			
43	520	537	XD-27			
44	520	537	XD-27			
45	540	557	XD-28			
46	540	557	XD-28			
47	560	577	XD-29			
48	560	577	XD-29			
49	580	597	XD-30			
50	580	597	XD-30			

Type No. of units	TQ-5,5			TQ-8,14		
	P	L	Rail designation	P	L	Rail designation
1	50	60	XF-60	50	60	XF-60
2	60	70	XF-70	65	75	XF-75
3	70	80	XF-80	80	90	XF-90
4	80	90	XF-90	95	105	XF-105
5	90	100	XF-100	105	115	XF-115
6	105	115	XF-115	120	130	XF-130
7	115	125	XF-125	135	145	XF-145
8	125	135	XF-135	150	160	XF-160
9	135	145	XF-145	165	175	XF-175
10	145	155	XF-155	175	185	XF-185
11	160	170	XF-170	190	200	XF-200
12	170	180	XF-180	205	215	XF-215
13	180	190	XF-190	220	230	XF-230
14	190	200	XF-200	235	245	XF-245
15	200	210	XF-210	245	255	XF-255
16	215	225	XF-225	260	270	XF-270
17	225	235	XF-235	275	285	XF-285
18	235	245	XF-245	290	300	XF-300
19	245	255	XF-255	305	315	XF-315
20	255	265	XF-265	315	325	XF-325
21	270	280	XF-280	330	340	XF-340
22	280	290	XF-290	345	355	XF-355
23	290	300	XF-300	360	370	XF-370
24	300	310	XF-310	375	385	XF-385
25	310	320	XF-320	385	395	XF-395
26	325	335	XF-335	400	410	XF-410
27	335	345	XF-345	415	425	XF-425
28	345	355	XF-355	430	440	XF-440
29	365	375	XF-375	445	455	XF-455
30	365	375	XF-375	455	465	XF-465
31	380	390	XF-390	470	480	XF-480
32	390	400	XF-400	485	495	XF-495
33	400	410	XF-410	500	510	XF-510
34	410	420	XF-420	515	525	XF-525
35	420	430	XF-430	525	535	XF-535
36	435	445	XF-445	540	550	XF-550
37	445	455	XF-455	555	565	XF-565
38	455	465	XF-465	570	580	XF-580
39	465	475	XF-475	585	595	XF-595
40	475	485	XF-485			
41	490	500	XF-500			
42	500	510	XF-510			
43	510	520	XF-520			
44	520	530	XF-530			
45	530	540	XF-540			
46	545	555	XF-555			
47	555	565	XF-565			
48	565	575	XF-575			
49	575	585	XF-585			
50	585	595	XF-595			

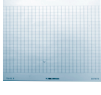
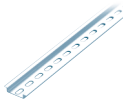
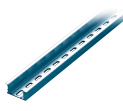
## ACCESSORIES

### Applicable accessories

Type	Accessories	End plate	Marker strip	Marker strip case	Marker sheet	Aluminum rail (applicable)	Aluminum rail (semi-applicable)
TQ-5.5							
TQ-8		TQE-5.5 A TQE-5.5 B	TUM-2 0.5T	TUM marker strip case 10	TJ-5.5 mark sheet	TXB (Standard DIN rail)	TKB (Reinforced DIN rail)
TQ-14	TQE-8 A TQE-8 B	TJ-14 mark sheet					
	TQE-14 A TQE-14 B	TJ-14 mark sheet					

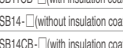
Type	Accessories	End clamp (applicable)	End clamp (semi-applicable)	Cover	Jumper	Remarks
TQ-5.5						Jumper: □ indicates the number of poles. 2P, 3P, 4P, 5P, 12P
TQ-8		TXL	TJL	TUC-6		
TQ-14						

### End plate

TQE-□A

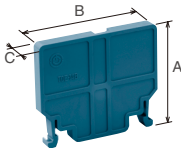

TQE-□B

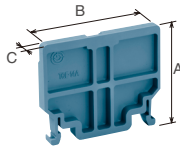

Type name	TQE-5.5A TQE-5.5B	TQE-8A TQE-8B	TQE-14A TQE-14B
Dimension			
A	33	38	38
B	40	45	45
C	5	5	5

■ **Marker strip** [Order unit: 100]

- TUM-2 0.5T

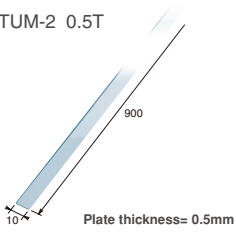

■ **Marker strip case** [Order unit: 100]

- TUM marker strip case 10

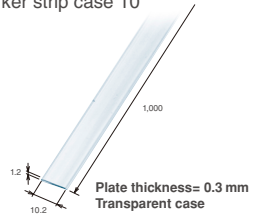

■ **Marker sheet** [Order unit: 100]

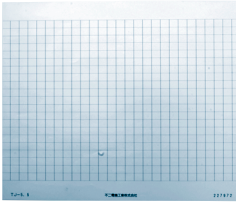

Type name	TJ-5.5 marker sheet	TJ-14 marker sheet
Pitch	11	14

■ **Aluminum rail**

- TXB (Standard DIN rail) [Order unit: 50]

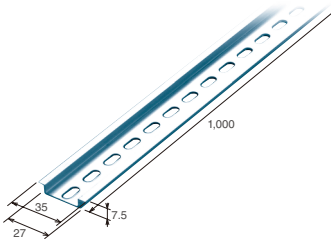

- TKB (Reinforced DIN rail) [Order unit: 20]

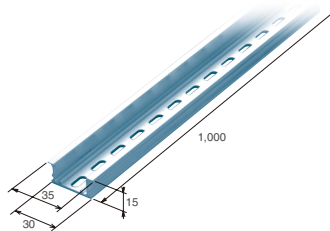

■ **End clamp** [Order unit: 100]

- TXL (applicable)
- TJL (semi-applicable)

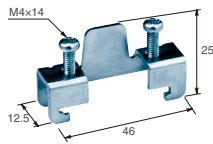
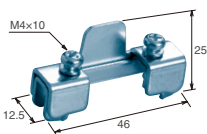

■ **Cover** [Order unit: 20]

- TUC-□

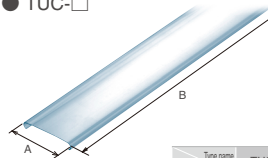

Type name	TUC-3	TUC-6
Dimension A	40	45
Dimension B	1000	1000

# TERMINAL

## ■ Jumper [Order unit: 10]

- SB11CB-□

Without insulation coat	SB11-□
With insulation coat (black)	SB11CB-□

dimensions		
------------	--	--

No. of units	2	3	4	5	12
L	20.5	31.5	42.5	53.5	130.5

- SB14CB-□

Without insulation coat	SB14-□
With insulation coat (black)	SB14CB-□

dimensions		
------------	--	--

No. of units	2	3	4	5	12
L	26	40	54	68	166

## ■ NP mount [Order unit: 50]

- TX NP mount S
- TX NP lens
- Set of TX NP mount S and lens



\* NP mount that can be attached to TXL (end clamp)

## ● ACCESSORIES FOR TEST TOOLS

### ■ Remover [Order unit: 1]

- MIC-NQ

Used to pull out a receptacle from the XC plug.

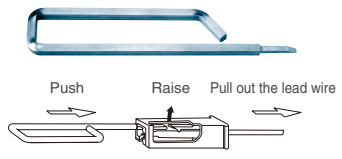

### ■ Plug [Order unit: 100]

- XC-P1-B

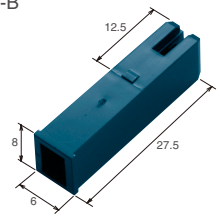

### ■ Receptacle contactor [Order unit: 100]

- (MIC) Mark II (manufactured by AMP)

\* Refer to the "IS-259J (91592-1)" and "IS-260J (755400-1)" crimping tool instruction manuals supplied by AMP.

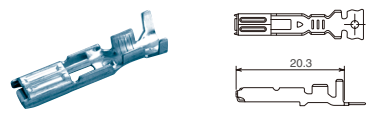

Applicable wire (mm <sup>2</sup> )	Insulation coat size	Material and finish	Model of receptacle		Instruction manual for tool
			Tape	Loose piece	
0.3 to 0.89	1.5 to 2.6	Brass / Tin plated	172775-1	172776-1	91592-1
		Brass / Partial gold plated	172775-2	172776-2	
		Phosphor bronze / Tin plated	172775-4	172776-4	
0.5 to 2.27	2.1 to 3.4	Brass / Tin plated	172773-1	172774-1	755400-1
		Brass / Partial gold plated	172773-2	172774-2	
		Phosphor bronze / Tin plated	172773-4	172774-4	



# ● WIRE DROPPING-OFF PREVENTION FUNCTION

## ■ Example of trouble

With conventional models, the terminal screw can be tightened even if the screw is not inserted in the screw hole of the crimp terminal. (See +1) In particular, when two wires are connected, a loose connection is difficult to detect in a visual inspection, if the lower terminal is pinched by the screw.

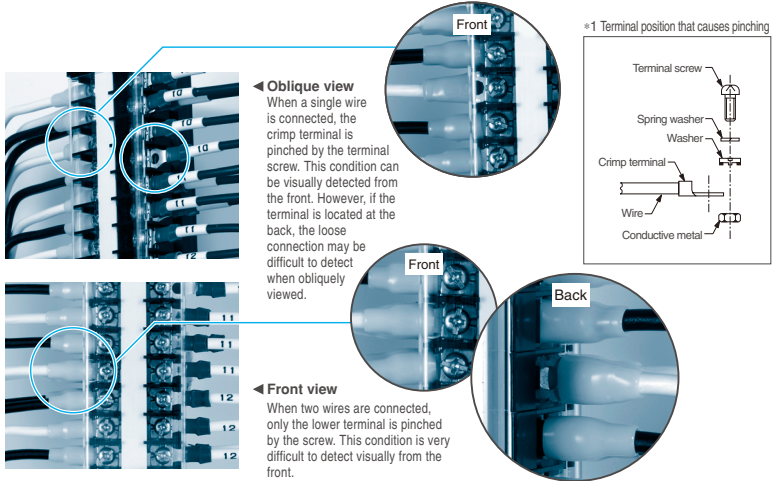

## Countermeasure

The guide ribs lead the crimp terminal to the proper position. (See +2)  
This structure prevents the crimp terminal from being pinched by the terminal screw because the terminal cannot be located at a position that causes pinching when the screw is tightened.

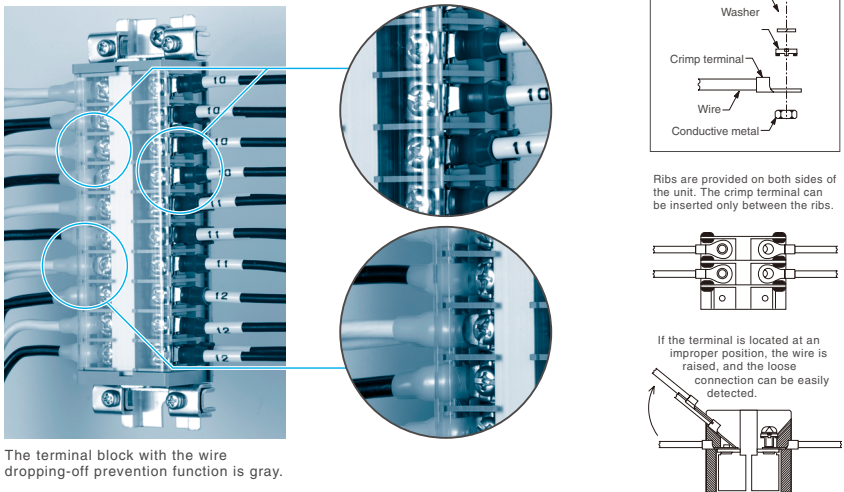

The terminal block with the wire dropping-off prevention function is gray.

## ● APPLICABLE TO TEST TOOLS

**Quick connection** → **Inspection time reduction**  
 Withstand voltage test  
 Sequence test } Quick connection possible

**Jumper plug (XC-P1)** → **Assembly time reduction**  
 The wire dropping-off prevention function greatly reduces wiring time.

**Marker strip attached** → **Inspection time reduction**  
 When the TJ-CH socket for tests is attached, in-factory test efficiency can be improved.

**Wire dropping-off prevention up-screw type**

**TQ type terminal block**      **Socket for tests**

\* Wires are supplied separately.

### ■ TJX-5.5CH 12P (Exclusive for 12 poles)

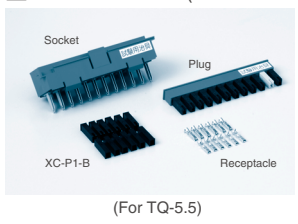

### ■ TJ-5.5CH [No. of poles] PC (Joint type)

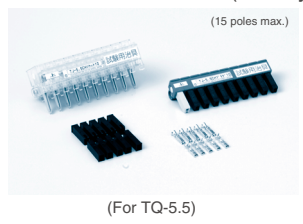

### ■ TJ-14CH [No. of poles] PC (Joint type)

