

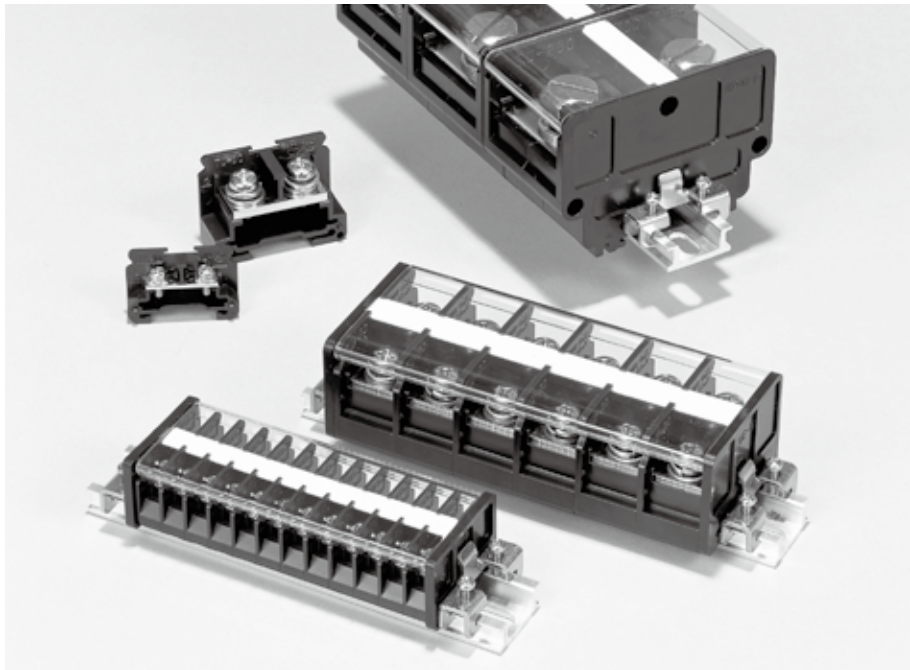

TU TYPE



(Some models unconformable)



FEATURES

- Terminal block standard model with wide variations from 10 A to 60 A
- For the insulating material of the unit block and end plate, a modified PPE resin with flame retardancy grade UL94V-0 is used.
- All resin materials use virgin materials and maintain high reliability for a long time.
- In addition to miniaturizing the unit design, the screw tightening strength has been increased, weight reduction, high quality has been realized.
- Low cost type by automated production, you can use it in a wide range of fields.
- Overseas standard compliant products.
- TSB rail specification with minimum height at rail installation added.
- According to your environment, stainless steel screw specifications are also available.

SPECIFICATIONS (RATINGS, PERFORMANCE)

Specification	Type	TU-10	TU-15	TU-15C	TU-20 TU-20BU	TU-30B TU-30BR	TU-50	TU-60	TU-80	TU-125	TU-150	TU-250	TU-400B	TU-600B	TU-15	TUP-15	
Rated insulation voltage (UI)	Pollution degree 2	600V	600V	1,000V	1,000V											600V	250V
	Pollution degree 3			600V	600V												
Rated current-carrying capacity (Ith)		10A	15A	25A	30A	50A	60A	80A	125A	150A	250A	400A	600A		15A		
Max. wire size		2mm ²		5.5mm ²			8mm ²	14mm ²	22mm ²	38mm ²	60mm ²	150mm ²	200mm ²	325mm ²	2mm ²		
Screw size		M3×8	M3.5×8		M4×10		M5×10	M6×12	M8×16		M10×25	M12×30	M16×35	M3.5×8			
Power-frequency withstand voltage		2,500V AC / 1 min.		3,000V AC / 1 min.		3,000V AC / 1 min.					5,000V AC / 1 min.			2,500V AC / 1 min.			
Rated impulse withstand voltage		—		8kV		8kV					12kV			—			
Lightning impulse		±7.2kV / 3 times for each pole (1.2 / 50 μs)		—		±7.2kV / 3 times for each pole (1.2 / 50 μs)					—			±8.0kV (1.2 / 50 μs)			
Ambient operating temperature		-25 to 60°C															
Storing temperature		-40 to 85°C															
Altitude		2,000 m or less															
Flame retardant grade		Unit: UL94V-0															

* Insulation treatment suitable for the working voltage should be applied to the crimp terminal.

* Consider with ambient operating temperature, current-carrying capacity, wire size, please use a heat-resistant wires as necessary.

How to order of terminal blocks

Product Composition

Necessary parts for assembling a terminal block

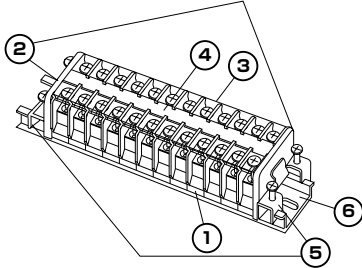

① Unit part ————— Refer to C91 to C94

② End plate

③ Cover (Standard length: 1,000 mm)

④ Marker strip (Standard length: 900 mm)

⑤ End clamp

⑥ Rail (Standard length: 1,000 mm)

Please check the accessory list (C101 to C102) and order by the compatible type name.

Remark: When purchasing single item accessories, please pay attention to each sales unit.

How to order assembly

Remark: If there is no indication of the rail, it will be rail assembly of U-cut type (UF).

1 One type assembly

TU-15 × 36 UD -17
 Type name No. of poles Rail Assembly dimensions

Remark: When separating by end plate, please specify separately.

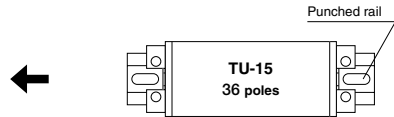

2 Mixing assembly

TU-15 × 12, TU-50 × 24 UF -475
 Type name No. of poles Type name No. of poles Rail Assembly dimensions

Remark: When combining the same dimensions, there is no separation of end plates.
 Please specify separately as necessary.

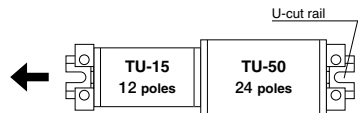

3 For stainless steel screw type (custom product)

TU-15 SUS × 36 UD -17 MR
 Type name Stainless steel screw No. of poles Rail Assembly dimensions Tropical region type

Information of tropical region type

Screw Stainless steel
 Rail Varnish coated
 End clamp..... Thick plated

Tropical region type nameplate (attached to end plate)

MOISTURE RESISTANCE

See page C95 to C100 for rail length some type combination.

* If the tropical region type is not specified, only the screws are made of stainless steel.



TU TYPE

STANDARD PRODUCTS

TU-10 (10A)

Applicable wire size: 0.75 to 2.0 mm²

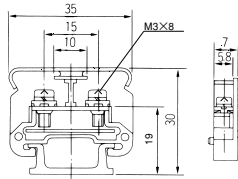

●Applicable accessories

End plate	TUE-2
Standard marker strip	TUM-2
Standard rail	TUB
End clamp	TUL
Cover	TUC-2

●Applicable crimp terminal

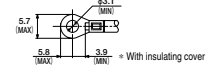

TU-15 (15A)

Applicable wire size: 0.75 to 2.0 mm²

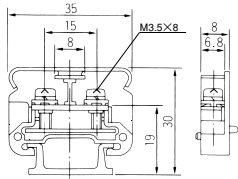

●Applicable accessories

End plate	TUE-2
Standard marker strip	TUM-1
Standard rail	TUB
End clamp	TUL
Cover	TUC-2

●Applicable crimp terminal

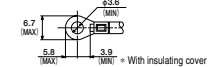

TU-15C (15A)

Applicable wire size: 0.75 to 2.0 mm²

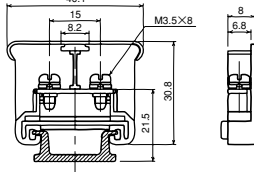
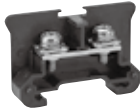

●Applicable accessories

End plate	TUE-2B
Standard marker strip	TUM-1
Standard rail	TUB
End clamp	TUL
Cover	TUC-3

●Applicable crimp terminal

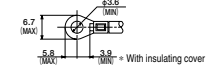

TU-20 (25A)

Applicable wire size: 0.75 to 5.5 mm²

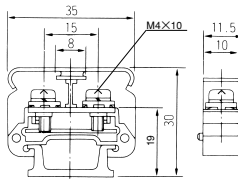
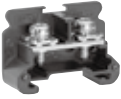

●Applicable accessories

End plate	TUE-2
Standard marker strip	TUM-1
Standard rail	TUB
End clamp	TUL
Cover	TUC-2

●Applicable crimp terminal

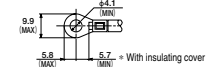

TU-30B (30A)

Applicable wire size: 0.75 to 5.5 mm²

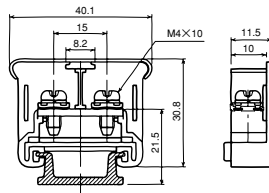
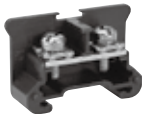

●Applicable accessories

End plate	TUE-2B
Standard marker strip	TUM-1
Standard rail	TUB
End clamp	TUL
Cover	TUC-3

●Applicable crimp terminal

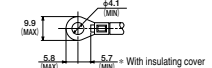

TU-50 (50A)

Applicable wire size: 2.0 to 8 mm²

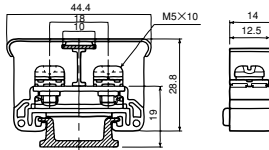

●Applicable accessories

End plate	TUE-5
Standard marker strip	TUM-2
Standard rail	TUB
End clamp	TUL
Cover	TUC-6

●Applicable crimp terminal

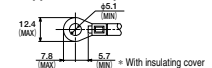

CONNECTING DEVICES

TU-60 (60A)

Applicable wire size: 3.5 to 14 mm²

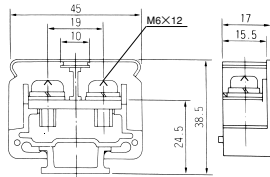

● Applicable accessories

End plate	TUE-6
Standard marker strip	TUM-2
Standard rail	TUB
End clamp	TUL
Cover	TUC-6

● Applicable crimp terminal

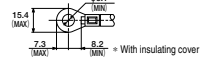

TU-80 (80A)

Applicable wire size: 5.5 to 22 mm²

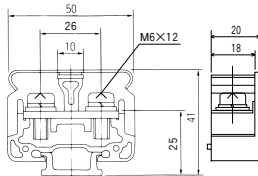

● Applicable accessories

End plate	TUE-8
Standard marker strip	TUM-2
Standard rail	TUB
End clamp	TUL
Cover	TUC-8

● Applicable crimp terminal

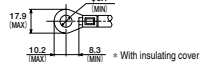

TU-125 (125A) Applicable to DIN rail

Applicable wire size: 14 to 38 mm²

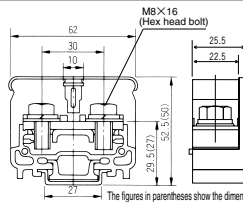

● Applicable accessories

End plate	TUE-15
Standard marker strip	TUM-2
Standard rail	TUB
End clamp	TUL
Cover	TUC-15

● Applicable crimp terminal

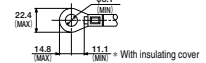

The figures in parentheses show the dimensions as with the TUB rail assembly.

TU-150 (150A) Applicable to DIN rail

Applicable wire size: 30 to 60 mm²

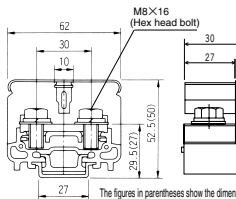

● Applicable accessories

End plate	TUE-15
Standard marker strip	TUM-2
Standard rail	TUB
End clamp	TUL
Cover	TUC-15

● Applicable crimp terminal

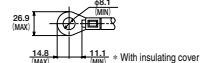

The figures in parentheses show the dimensions as with the TUB rail assembly.

TU-250 (250A) Applicable to DIN rail

Applicable wire size: 100 to 150 mm²

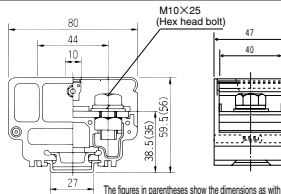

● Applicable accessories

Standard marker strip	With TUM-3
Standard rail	TUB
End clamp	TUL
Cover	With TUC-25
Connecting pin	TU-400B pin (selling separately)

● Applicable crimp terminal

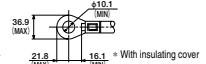

The figures in parentheses show the dimensions as with the TUB rail assembly.

A SWITCH

B PILOT LAMP & INDICATOR

C CONNECTING DEVICES

D ELECTRONIC DEVICES

E CONTROL CENTER PARTS



TU TYPE

STANDARD PRODUCTS

TU-400B (400A) DIN rail

Applicable to DIN rail
Applicable wire size: 150 to 200 mm²



(For the use of crimp terminal protection)
TUC-60 cover

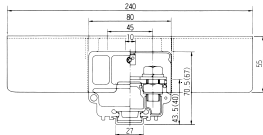
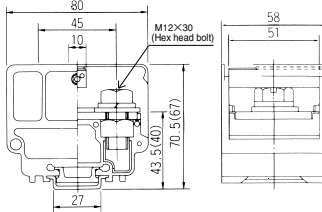
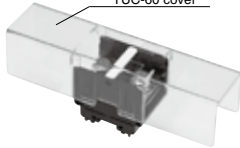

The figures in parentheses show the dimensions as with the TUB rail assemble.

●Applicable accessories

Standard marker strip	With TUM-4
Standard rail	TUB
End clamp	TUL
Cover	With TUC-40
Connecting pin	TU-400B pin (selling separately) TU-600B pin (selling separately) (In case of with TUC-60)

●Applicable crimp terminal

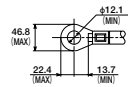

+ With insulating cover

(When connecting pins are used.)

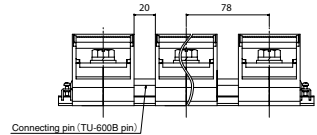

TU-600B (600A) DIN rail

Applicable to DIN rail
Applicable wire size: 250 to 325 mm²



(For protection up to crimp terminal)
TUC-60 cover

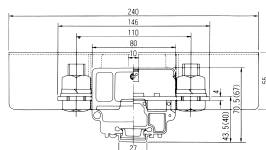
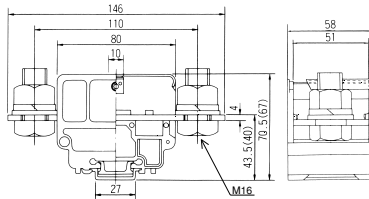
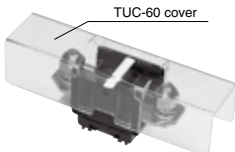

The figures in parentheses show the dimensions as with the TUB rail assemble.

●Applicable accessories

Standard marker strip	With TUM-4
Standard rail	TUB
End clamp	TUL
Cover	With TUC-40
Connecting pin	TU-600B pin

●Applicable crimp terminal

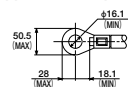

+ With insulating cover

(When connecting pins are used.)

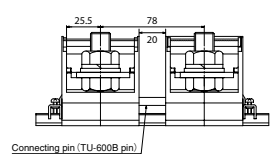

SPECIAL SPECIFICATION PRODUCTS

Solder terminal: Both solder and crimp terminal are available.

TUS-15 (15A)

Applicable wire size: 0.75 to 2.0 mm²

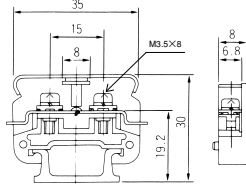

● **Applicable accessories**

End plate	TUE-2
Standard marker strip	TUM-1
Standard rail	TUB
End clamp	TUL
Cover	TUC-2

● **Applicable crimp terminal**

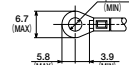

* With insulating cover

Wrapping terminal: Up to 4 wire-wrap wires can be connected on one side.

TUP-15 (15A)

Applicable wire size: 0.75 to 2.0 mm²

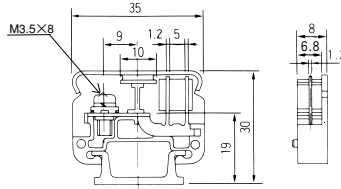
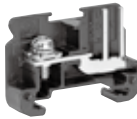

● **Applicable accessories**

End plate	TUE-2
Standard marker strip	TUM-2
Standard rail	TUB
End clamp	TUL
Cover	TUC-2

● **Applicable crimp terminal**

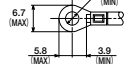

* With insulating cover

Light-blue terminal: Use for safety and explosion-proof construction.

TU-20BU (25A)

Applicable wire size: 0.75 to 5.5 mm²

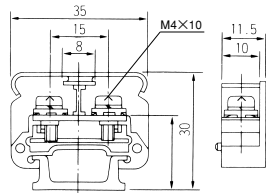
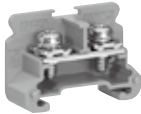

● **Applicable accessories**

End plate	TUE-2 (BL)
Standard marker strip	TUM-1
Standard rail	TUB
End clamp	TUL
Cover	TUC-2

● **Applicable crimp terminal**

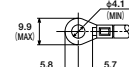

* With insulating cover

Red terminal: Use for a trip circuit, etc.

TU-30SR (30A)

Applicable wire size: 1.25 to 5.5 mm²

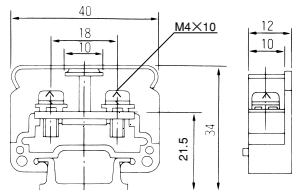
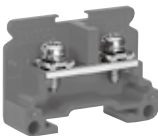

● **Applicable accessories**

End plate	TUE-3 (R)
Standard marker strip	TUM-2
Standard rail	TUB
End clamp	TUL
Cover	TUC-3

● **Applicable crimp terminal**

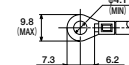

* With insulating cover



TU TYPE

TABLE OF ASSEMBLED DIMENSIONS

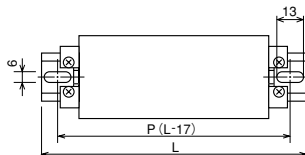

TU type assembly on punched rail

TUB-D type

Type Pole	TU-10			TU-15,TU-15C,TUS-15,TUP-15			TU-20,TU-30B,30BR,20BU,TU-FSM,FS			TU-50			TU-60			Type Pole
	P	L	Rail	P	L	Rail	P	L	Rail	P	L	Rail	P	L	Rail	
1	60	77	UD-4	60	77	UD-4	60	77	UD-4	60	77	UD-4	60	77	UD-4	1
2	60	77	UD-4	60	77	UD-4	60	77	UD-4	60	77	UD-4	60	77	UD-4	2
3	60	77	UD-4	60	77	UD-4	60	77	UD-4	80	97	UD-5	80	97	UD-5	3
4	60	77	UD-4	60	77	UD-4	80	97	UD-5	80	97	UD-5	100	117	UD-6	4
5	60	77	UD-4	60	77	UD-4	80	97	UD-5	100	117	UD-6	120	137	UD-7	5
6	60	77	UD-4	80	97	UD-5	100	117	UD-6	100	117	UD-6	120	137	UD-7	6
7	80	97	UD-5	80	97	UD-5	100	117	UD-6	120	137	UD-7	140	157	UD-8	7
8	80	97	UD-5	100	117	UD-6	120	137	UD-7	140	157	UD-8	160	177	UD-9	8
9	80	97	UD-5	100	117	UD-6	140	157	UD-8	160	177	UD-9	180	197	UD-10	9
10	100	117	UD-6	100	117	UD-6	140	157	UD-8	160	177	UD-9	200	217	UD-11	10
11	100	117	UD-6	120	137	UD-7	160	177	UD-9	180	197	UD-10	220	237	UD-12	11
12	100	117	UD-6	120	137	UD-7	160	177	UD-9	200	217	UD-11	240	257	UD-13	12
13	120	137	UD-7	140	157	UD-8	180	197	UD-10	220	237	UD-12	240	257	UD-13	13
14	120	137	UD-7	140	157	UD-8	180	197	UD-10	220	237	UD-12	260	277	UD-14	14
15	120	137	UD-7	140	157	UD-8	200	217	UD-11	240	257	UD-13	280	297	UD-15	15
16	140	157	UD-8	160	177	UD-9	220	237	UD-12	260	277	UD-14	300	317	UD-16	16
17	140	157	UD-8	160	177	UD-9	220	237	UD-12	260	277	UD-14	320	337	UD-17	17
18	140	157	UD-8	180	197	UD-10	240	257	UD-13	280	297	UD-15	340	357	UD-18	18
19	160	177	UD-9	180	197	UD-10	240	257	UD-13	300	317	UD-16	360	377	UD-19	19
20	160	177	UD-9	180	197	UD-10	260	277	UD-14	300	317	UD-16	360	377	UD-19	20
21	180	197	UD-10	200	217	UD-11	280	297	UD-15	320	337	UD-17	380	397	UD-20	21
22	180	197	UD-10	200	217	UD-11	280	297	UD-15	340	357	UD-18	400	417	UD-21	22
23	180	197	UD-10	220	237	UD-12	300	317	UD-16	360	377	UD-19	420	437	UD-22	23
24	200	217	UD-11	220	237	UD-12	300	317	UD-16	360	377	UD-19	440	457	UD-23	24
25	200	217	UD-11	220	237	UD-12	320	337	UD-17	380	397	UD-20	460	477	UD-24	25
26	200	217	UD-11	240	257	UD-13	320	337	UD-17	400	417	UD-21	480	497	UD-25	26
27	220	237	UD-12	240	257	UD-13	340	357	UD-18	400	417	UD-21	480	497	UD-25	27
28	220	237	UD-12	260	277	UD-14	360	377	UD-19	420	437	UD-22	500	517	UD-26	28
29	220	237	UD-12	260	277	UD-14	360	377	UD-19	440	457	UD-23	520	537	UD-27	29
30	240	257	UD-13	260	277	UD-14	380	397	UD-20	460	477	UD-24	540	557	UD-28	30
31	240	257	UD-13	280	297	UD-15	380	397	UD-20	460	477	UD-24	560	577	UD-29	31
32	240	257	UD-13	280	297	UD-15	400	417	UD-21	480	497	UD-25	580	597	UD-30	32
33	260	277	UD-14	300	317	UD-16	420	437	UD-22	500	517	UD-26				33
34	260	277	UD-14	300	317	UD-16	420	437	UD-22	500	517	UD-26				34
35	260	277	UD-14	300	317	UD-16	440	457	UD-23	520	537	UD-27				35
36	280	297	UD-15	320	337	UD-17	440	457	UD-23	540	557	UD-28				36
37	280	297	UD-15	320	337	UD-17	460	477	UD-24	560	577	UD-29				37
38	280	297	UD-15	340	357	UD-18	460	477	UD-24	560	577	UD-29				38
39	300	317	UD-16	340	357	UD-18	480	497	UD-25	580	597	UD-30				39
40	300	317	UD-16	340	357	UD-18	500	517	UD-26							40
41	320	337	UD-17	360	377	UD-19	500	517	UD-26							41
42	320	337	UD-17	360	377	UD-19	520	537	UD-27							42
43	320	337	UD-17	380	397	UD-20	520	537	UD-27							43
44	340	357	UD-18	380	397	UD-20	540	557	UD-28							44
45	340	357	UD-18	380	397	UD-20	540	557	UD-28							45
46	340	357	UD-18	400	417	UD-21	560	577	UD-29							46
47	360	377	UD-19	400	417	UD-21	560	577	UD-29							47
48	360	377	UD-19	420	437	UD-22	580	597	UD-30							48
49	360	377	UD-19	420	437	UD-22										49
50	380	397	UD-20	420	437	UD-22										50
51	380	397	UD-20	440	457	UD-23										51
52	380	397	UD-20	440	457	UD-23										52
53	400	417	UD-21	460	477	UD-24										53
54	400	417	UD-21	460	477	UD-24										54
55	400	417	UD-21	460	477	UD-24										55
56	420	437	UD-22	480	497	UD-25										56
57	420	437	UD-22	480	497	UD-25										57
58	440	457	UD-23	500	517	UD-26										58
59	440	457	UD-23	500	517	UD-26										59
60	440	457	UD-23	500	517	UD-26										60

CONNECTING DEVICES

Type Pole	TU-80			TU-125			TU-150			TU-250			TU-400B			Type Pole
	P	L	Rail	P	L	Rail	P	L	Rail	P	L	Rail	P	L	Rail	
1	60	77	UD-4	60	77	UD-4	60	77	UD-4	60	77	UD-4	80	97	UD-5	1
2	60	77	UD-4	80	97	UD-5	80	97	UD-5	120	137	UD-7	140	157	UD-8	2
3	80	97	UD-5	100	117	UD-6	120	137	UD-7	160	177	UD-9	200	217	UD-11	3
4	100	117	UD-6	120	137	UD-7	140	157	UD-8	200	217	UD-11	260	277	UD-14	4
5	120	137	UD-7	140	157	UD-8	180	197	UD-10	260	277	UD-14	320	337	UD-17	5
6	140	157	UD-8	180	197	UD-10	200	217	UD-11	300	317	UD-16	360	377	UD-19	6
7	160	177	UD-9	200	217	UD-11	240	257	UD-13	360	377	UD-19	420	437	UD-22	7
8	180	197	UD-10	220	237	UD-12	260	277	UD-14	400	417	UD-21	480	497	UD-25	8
9	200	217	UD-11	260	277	UD-14	300	317	UD-16	440	457	UD-23	540	557	UD-28	9
10	220	237	UD-12	280	297	UD-15	320	337	UD-17	500	517	UD-26				10
11	240	257	UD-13	300	317	UD-16	360	377	UD-19	540	557	UD-28				11
12	260	277	UD-14	340	357	UD-18	380	397	UD-20	580	597	UD-30				12
13	280	297	UD-15	360	377	UD-19	400	417	UD-21							13
14	300	317	UD-16	380	397	UD-20	440	457	UD-23							14
15	320	337	UD-17	400	417	UD-21	480	497	UD-25							15
16	340	357	UD-18	440	457	UD-23	500	517	UD-26							16
17	360	377	UD-19	460	477	UD-24	540	557	UD-28							17
18	380	397	UD-20	480	497	UD-25	560	577	UD-29							18
19	400	417	UD-21	500	517	UD-26										19
20	420	437	UD-22	540	557	UD-28										20
21	440	457	UD-23	560	577	UD-29										21
22	460	477	UD-24	580	597	UD-30										22
23	480	497	UD-25													23
24	500	517	UD-26													24
25	520	537	UD-27													25
26	540	557	UD-28													26
27	560	577	UD-29													27
28	580	597	UD-30													28

Type Pole	TU-600B															Type Pole
	P	L	Rail													
1	80	97	UD-5													1
2	160	177	UD-9													2
3	240	257	UD-13													3
4	320	337	UD-17													4
5	400	417	UD-21													5
6	480	497	UD-25													6

A SWITCH

B PILOT LAMP & INDICATOR

C CONNECTING DEVICES

D ELECTRONIC DEVICES

E CONTROL CENTER PARTS

CONNECTING DEVICES

Type Pole	TU-80			TU-125			TU-150			TU-250			TU-400B			Type Pole
	P	L	Rail	P	L	Rail	P	L	Rail	P	L	Rail	P	L	Rail	
1	45	55	UF-55	50	60	UF-60	55	65	UF-65	65	75	UF-75	75	85	UF-85	1
2	65	75	UF-75	75	85	UF-85	85	95	UF-95	110	120	UF-120	135	145	UF-145	2
3	85	95	UF-95	100	110	UF-110	115	125	UF-125	160	170	UF-170	190	200	UF-200	3
4	105	115	UF-115	125	135	UF-135	145	155	UF-155	205	215	UF-215	250	260	UF-260	4
5	125	135	UF-135	150	160	UF-160	175	185	UF-185	255	265	UF-265	310	320	UF-320	5
6	145	155	UF-155	175	185	UF-185	205	215	UF-215	300	310	UF-310	365	375	UF-375	6
7	165	175	UF-175	200	210	UF-210	235	245	UF-245	350	360	UF-360	425	435	UF-435	7
8	185	195	UF-195	230	240	UF-240	265	275	UF-275	395	405	UF-405	485	495	UF-495	8
9	205	215	UF-215	255	265	UF-265	295	305	UF-305	440	450	UF-450	540	550	UF-550	9
10	225	235	UF-235	280	290	UF-290	325	335	UF-335	490	500	UF-500				10
11	245	255	UF-255	305	315	UF-315	355	365	UF-365	535	545	UF-545				11
12	265	275	UF-275	330	340	UF-340	385	395	UF-395	585	595	UF-595				12
13	285	295	UF-295	355	365	UF-365	415	425	UF-425							13
14	305	315	UF-315	380	390	UF-390	445	455	UF-455							14
15	325	335	UF-335	405	415	UF-415	475	485	UF-485							15
16	345	355	UF-355	430	440	UF-440	505	515	UF-515							16
17	365	375	UF-375	455	465	UF-465	535	545	UF-545							17
18	385	395	UF-395	485	495	UF-495	565	575	UF-575							18
19	405	415	UF-415	510	520	UF-520										19
20	425	435	UF-435	535	545	UF-545										20
21	445	455	UF-455	560	570	UF-570										21
22	465	475	UF-475	585	595	UF-595										22
23	485	495	UF-495													23
24	505	515	UF-515													24
25	525	535	UF-535													25
26	545	555	UF-555													26
27	565	575	UF-575													27
28	585	595	UF-595													28

Type Pole	TU-600B															Type Pole
	P	L	Rail													
1	75	85	UF-85													1
2	155	165	UF-165													2
3	240	250	UF-250													3
4	320	330	UF-330													4
5	400	410	UF-410													5
6	480	490	UF-490													6
7	565	575	UF-575													7

A SWITCH

PILOT LAMP &
INDICATOR

CONNECTING
DEVICES

ELECTRONIC
DEVICES

CONTROL
CENTER PARTS



TU TYPE

TABLE OF ASSEMBLED DIMENSIONS

TU type assembly on U-cut rail

TSB-F type

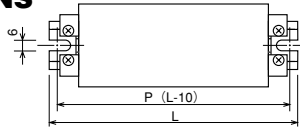

Type Pole	TU-10			TU-15, TU-15C, TUS-15, TUP-15			TU-20, TU-30B, 30BR, 20BU, TU-FSM, FS			TU-50			TU-60			Type Pole
	P	L	Rail	P	L	Rail	P	L	Rail	P	L	Rail	P	L	Rail	
1	35	45	SF-45	35	45	SF-45	35	45	SF-45	40	50	SF-50	40	50	SF-50	1
2	40	50	SF-50	40	50	SF-50	50	60	SF-60	55	65	SF-65	60	70	SF-70	2
3	50	60	SF-60	50	60	SF-60	60	70	SF-70	70	80	SF-80	75	85	SF-85	3
4	55	65	SF-65	55	65	SF-65	70	80	SF-80	80	90	SF-90	95	105	SF-105	4
5	65	75	SF-75	65	75	SF-75	85	95	SF-95	95	105	SF-105	110	120	SF-120	5
6	70	80	SF-80	70	80	SF-80	95	105	SF-105	110	120	SF-120	125	135	SF-135	6
7	75	85	SF-85	80	90	SF-90	105	115	SF-115	125	135	SF-135	145	155	SF-155	7
8	85	95	SF-95	90	100	SF-100	115	125	SF-125	140	150	SF-150	160	170	SF-170	8
9	90	100	SF-100	95	105	SF-105	130	140	SF-140	150	160	SF-160	180	190	SF-190	9
10	100	110	SF-110	105	115	SF-115	140	150	SF-150	165	175	SF-175	195	205	SF-205	10
11	105	115	SF-115	110	120	SF-120	155	165	SF-165	180	190	SF-190	215	225	SF-225	11
12	110	120	SF-120	120	130	SF-130	165	175	SF-175	195	205	SF-205	230	240	SF-240	12
13	120	130	SF-130	130	140	SF-140	175	185	SF-185	205	215	SF-215	245	255	SF-255	13
14	125	135	SF-135	135	145	SF-145	185	195	SF-195	220	230	SF-230	265	275	SF-275	14
15	135	145	SF-145	145	155	SF-155	200	210	SF-210	235	245	SF-245	280	290	SF-290	15
16	140	150	SF-150	150	160	SF-160	210	220	SF-220	250	260	SF-260				16
17	145	155	SF-155	160	170	SF-170	220	230	SF-230	265	275	SF-275				17
18	155	165	SF-165	170	180	SF-180	235	245	SF-245	275	285	SF-285				18
19	160	170	SF-170	175	185	SF-185	245	255	SF-255	290	300	SF-300				19
20	170	180	SF-180	185	195	SF-195	255	265	SF-265							20
21	175	185	SF-185	195	205	SF-205	270	280	SF-280							21
22	185	195	SF-195	200	210	SF-210	280	290	SF-290							22
23	190	200	SF-200	210	220	SF-220	290	300	SF-300							23
24	195	205	SF-205	215	225	SF-225										24
25	205	215	SF-215	225	235	SF-235										25
26	210	220	SF-220	235	245	SF-245										26
27	220	230	SF-230	240	250	SF-250										27
28	225	235	SF-235	250	260	SF-260										28
29	230	240	SF-240	255	265	SF-265										29
30	240	250	SF-250	265	275	SF-275										30
31	245	255	SF-255	275	285	SF-285										31
32	255	265	SF-265	280	290	SF-290										32
33	260	270	SF-270	290	300	SF-300										33
34	265	275	SF-275													34
35	275	285	SF-285													35
36	280	290	SF-290													36
37	290	300	SF-300													37

CONNECTING DEVICES

Type Pole	TU-80			Type Pole
	P	L	Rail	
1	45	55	SF-55	1
2	65	75	SF-75	2
3	85	95	SF-95	3
4	105	115	SF-115	4
5	125	135	SF-135	5
6	145	155	SF-155	6
7	165	175	SF-175	7
8	185	195	SF-195	8
9	205	215	SF-215	9
10	225	235	SF-235	10
11	245	255	SF-255	11
12	265	275	SF-275	12
13	285	295	SF-295	13

A SWITCH

B PILOT LAMP &
INDICATOR

C CONNECTING
DEVICES

D ELECTRONIC
DEVICES





E CONTROL
CENTER PARTS







TU TYPE

ACCESSORIES

LIST OF APPLICABLE ACCESSORIES

Accessory		End plate	Marker strip		Marker strip case	Marker sheet
			Applicable	Semi-applicable		
Type						
			Applicable	Semi-applicable		
TU TYPE	TU-10	TUE-2	TUM-2	—	TUM marker strip case 10	—
	TU-15		TUM-1	—	TUM marker strip case 8	TU-15 marker sheet
	TU-15C			—		TU-20 marker sheet
	TU-20	—				
	TU-20BU	—				
	TU-30B	—				
	TU-30BR	—		TUM-2		TU-30 marker sheet
	TU-50	—	TU-30S, 60 marker sheet			
	TU-60	—	TU-80, 125 marker sheet			
	TU-80	—	TU-150, 250 marker sheet			
	TU-125	—	—			
	TU-150	—	—			
	TU-250	—	TUM-3	—	TU-400B marker sheet	
	TU-400B	—	TUM-4	—	—	
	TU-600B	—		—		
	TUS-15	TUE-2	TUM-1	—	TUM marker strip case 8	TU-15 marker sheet
	TUP-15		TUM-2	—	TUM marker strip case 10	TU-20 marker sheet
	TU-FS			—		

CONNECTING DEVICES

Aluminum rail		End clamp		Cover	Jumper	Accessory		
						Type		
Applicable	Semi-applicable	Applicable	Semi-applicable					
TUB	---	TUL	---	TUC-2, TUC-2-V0	SB8RCB, SB8CB	TU-10	TU TYPE	
	---		---			TU-15		
	---		---	TUC-3, TUC-3-V0	TU-15C			
	---		---	TUC-2, TUC-2-V0	TU-20			
	---		---	TUC-2, TUC-2-V0	TU-20BU			
	---		---	TUC-3, TUC-3-V0	TU-30B			
	---		---	TUC-3, TUC-3-V0	TU-30BR			
	---		---	TUC-6, TUC-6-V0	TU-50			
	---		---	TUC-8, TUC-8-V0	TU-60			
	---		---	TUC-8, TUC-8-V0	TU-80			
	TXB, TKB		---	TXL, TJL TUL-W	TUC-15, TUC-15-V0	---		TU-125
					TUC-25, TUC-25-V0	---		TU-150
					TUC-40, TUC-60, TUC-40-V0	---		TU-250
					TUC-40, TUC-60, TUC-40-V0	---		TU-400B
					TUC-40, TUC-60, TUC-40-V0	---		TU-600B
					TUC-2, TUC-2-V0	SB8RCB, SB8CB		TUS-15
---	---	TUC-2, TUC-2-V0	SB11.5CB	TUP-15				
---	---	TUC-2, TUC-2-V0	---	TU-FS				

A SWITCH

B PILOT LAMP &
INDICATOR

C CONNECTING
DEVICES

D ELECTRONIC
DEVICES

E CONTROL
CENTER PARTS



TU TYPE

ACCESSORIES

End plate

(Order unit: 100)

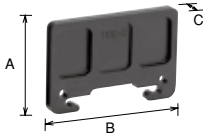

Type name	TUE-2 TUE-2 (BL)	TUE-3 TUE-3 (R)	TUE-5	TUE-6	TUE-8	TUE-15
A	25	29	29	33.5	36	45
B	38	40	45	45	50	62
C	3	3	3	3	3	3

Marker strip

(Order unit: 100)

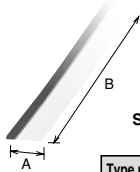

Standard thickness: t = 1.0 mm

Type name	TUM-1*	TUM-2*	TUM-3	TUM-4
A	8	10	10	10
B	900	900	45	55

* Plate thickness: 0.5 mm available

Connecting pin

(Order unit: 100)

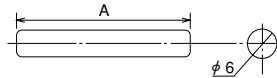

* Necessary when TUC-60 cover is attached.

Type name	TU-400B pin	TU-600B pin
A	20	40

Marker strip case

(Order unit: 100)

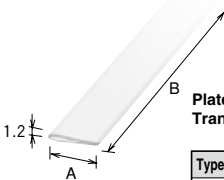

Plate thickness: t = 0.3 mm
Transparent case

Type name	TUM marker strip case 8	TUM marker strip case 10
A	8	10.2
B	1,000	1,000

Marker sheet

(Order unit: 100)



Type name	TU-15 marker sheet	TU-20 marker sheet	TU-30S, 60 marker sheet	TU-30 marker sheet
Pitch	8	11.5	12, 17	14
Type name	TU-80, 125 marker sheet	TU-150, 250 marker sheet	TU-400B marker sheet	
Pitch	20, 25.5	30, 44.6	54, 8	

Aluminum rail

(Order unit: 50)

●TUB

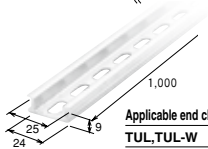
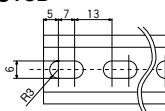

●TSB

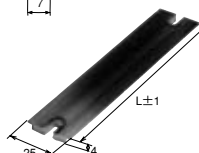
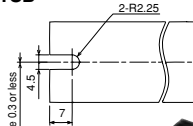

●TXB (DIN rail)

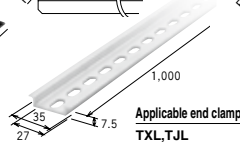
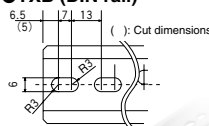

●TKB (reinforced DIN rail)

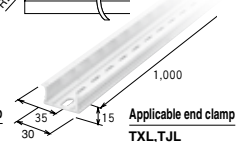
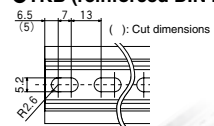

End clamp

(Order unit: 50)

●TUL (for TUB)

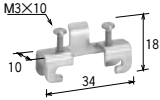

●TUL-W (for TUB)

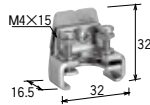

●TXL (for TXB)

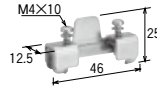

●TJL (for TXB)

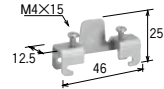

Cover

(Order unit: 20)

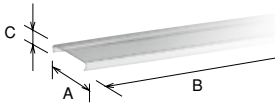

Type name	TUC-2 TUC-2-V0	TUC-3 TUC-3-V0	TUC-6 TUC-6-V0	TUC-8 TUC-8-V0	TUC-15 TUC-15-V0	TUC-25 TUC-25-V0	TUC-40 TUC-40-V0
A	35	40	45	50	62	80	80
B	1,000	1,000	1,000	1,000	1,000	45	55
C	5.6	5.6	5.6	7	7.5	7.5	7.5

* The end "V0" is a flame retardant grade UL94V-0 specification product.

●TUC-60

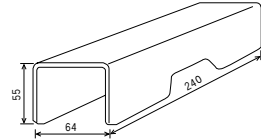

Long cover for terminal block and crimp terminal.
When attach the TUC-60 cover, it's necessary to open a space by TU-600B pin.

Jumper

(Order unit: 10)

Dimensions	2 poles	SB8CB-2	SB8RCB-2	SB11.5CB-2	SB12CB-2	SB14CB-2
	12 poles	SB8CB-12	SB8RCB-12	SB11.5CB-12	SB12CB-12	SB14CB-12

Name plate mount

(Order unit: 50)

●TX NP mount S

●TX NP mount lens



* The NP mount can be attached to TXL (end clamp).

(Assembled state)

Rail cap

Please refer to the page C15 for the rail cap.