

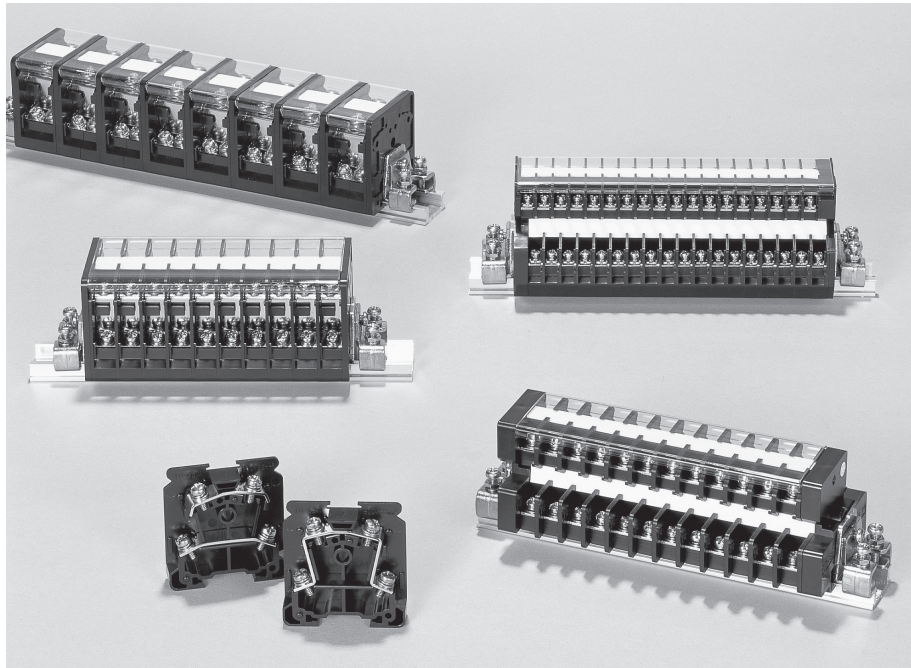

SCREW TYPE TERMINAL BLOCK

TU-□W TYPE



FEATURES

- TU-□W type is width space saving type with 2 stages in one unit.
- Stainless steel screw specifications are also available.

SPECIFICATIONS (RATINGS, PERFORMANCE)

Type	TU-15W	TU-20W	TU-25W	TU-25NW	TU-25SW	TU-25CW
Rated insulation voltage (UI)	600V					
Rated current-carrying capacity (Ith)	15A	20A		25A		50A
Rated cross-section	2mm ²			5.5mm ²	Upper side: 14mm ² Lower side: 5.5mm ²	
Screw size	M3.5×8	M4×8		M4×9	Upper side: M5×10 Lower side: M4× 9	
Number of conductors simultaneously connectable	2					
Power-Frequency withstand voltage	2,500V AC / 1 min.					
Rated impulse withstand voltage	±7.2kV / 3 times for each pole (1.2 / 50 μs)					
Ambient operating temperature	-20 to 50°C					
Storing temperature	-40 to 85°C					
Altitude	2,000 m or less					

* Rated insulation voltage of TU-15W (UL correspond) is 300V AC / DC.

CONNECTING DEVICES

How to order

TU - 15W ① **SUS** × ② **10** ③ **UF - 135** ④ **MR** ⑤

(blank) standard
MR* tropical region type
* applicable models only

● Information of tropical region type
Screw Stainless steel
Rail Varnish coated
End clamp Thick plated
Tropical region type nameplate (attached to end plate) MIXTURE RESISTANCE

No.	Item	Code	Detail	Remark	
①	Basic type	TU-□W			
②	Screw type	(blank)	Iron screw		
		SUS	Stainless steel screw	Conform to CE UL, TÜV certification are not applicable	
③	Pole No.	1 to max.	TU-15W	1 to 60	Max. pole No. is less than 600mm of rail length. (If only the TU-15SW is over 600mm, max. pole No. is less than 1,000mm of reinforced rail (TKB-D).)
			TU-20W	1 to 51	
			TU-25W	1 to 47	
			TU-25NW	1 to 47	
			TU-25SW	1 to 47	
④	Rail	UD	TUB-D rail type	Punched rail (Recommended maximum length : 600mm)	
		UF	TUB-F rail type	U-cut rail (Recommended maximum length : 600mm)	
⑤	Tropical region type	(blank)		Standard	
		MR	Tropical region type	Special model/Conform to CE UL, TÜV certification are not applicable (If you would like tropical region type, please indicate the stainless steel screw as well.)	

* For purchase of a single unit, specify ① and ② only.

STANDARD PRODUCTS

TU-15W (15A) Compatible with DIN

Applicable wire size: 0.75 to 2.0 mm² (M3.5)

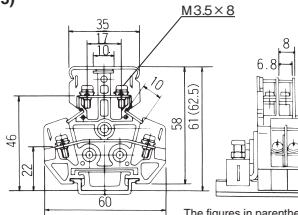
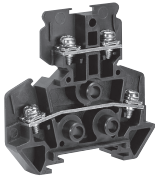

The figures in parentheses show the dimensions as with the DIN rail assemble.

● Applicable accessories

End plate **TUE-15 WA**
TUE-15 WB

Standard marker strip **TUM-2**
(top and bottom)

Standard rail **TUB**

End clamp **TUL-W**

Cover **TUC-2**

● Applicable crimp terminal

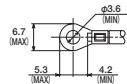

● With insulating cover

TU-20W (20A)

Applicable wire size: 0.75 to 2.0 mm² (M4)

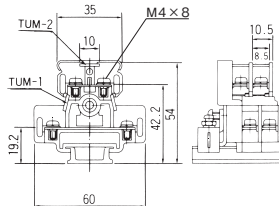
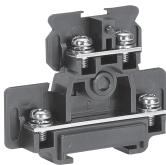

● Applicable accessories

End plate **TUE-20W**

Standard marker strip **TUM-2** (top) ·
TUM-1 (bottom)

Standard rail **TUB**

End clamp **TUL-W**

Cover **TUC-2**

● Applicable crimp terminal

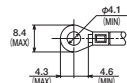

● With insulating cover



SCREW TYPE TERMINAL BLOCK

TU-W TYPE

STANDARD PRODUCTS

TU-25W (25A)

Applicable wire size: 1.25 to 5.5 mm² (M4)

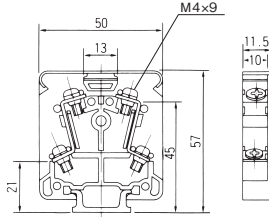
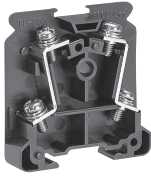

● Applicable accessories

End plate	TUE-25WA (with hole)
	TUE-25WB (without hole)
Standard marker strip	TUM-13

Standard rail	TUB
End clamp	TUL-W
Cover	TUC-8

● Applicable crimp terminal

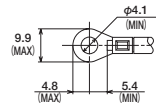

* With insulating cover

TU-25NW (25A)

Applicable wire size: 1.25 to 5.5 mm² (M4)

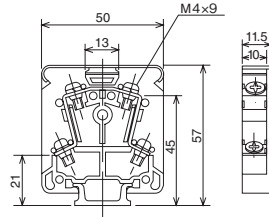
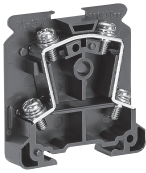

● Applicable accessories

End plate	TUE-25WA (with hole)
	TUE-25WB (without hole)
Standard marker strip	TUM-13

Standard rail	TUB
End clamp	TUL-W
Cover	TUC-8

● Applicable crimp terminal

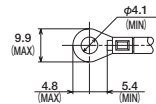

* With insulating cover

TU-25SW (25A)

Applicable wire size: 1.25 to 5.5 mm² (M4)

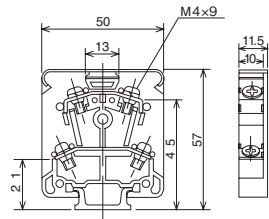
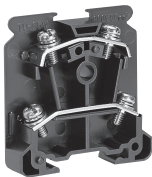

● Applicable accessories

End plate	TUE-25WA (with hole)
	TUE-25WB (without hole)
Standard marker strip	TUM-13

Standard rail	TUB
End clamp	TUL-W
Cover	TUC-8

● Applicable crimp terminal

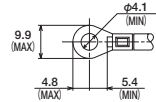

* With insulating cover

TU-25CW (50A)

Applicable wire size: 5.5 to 14 mm² (M5)
(Upper side)

Applicable wire size: 1.25 to 5.5 mm² (M4)
(Lower side)

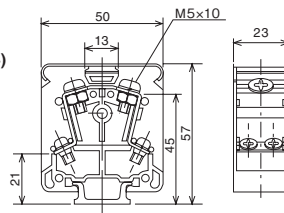

● Applicable accessories

End plate	TUE-25WA (with hole)
Standard marker strip	TUM-13
Standard rail	TUB

End clamp	TUL-W
Cover	TUC-8

● Applicable crimp terminal

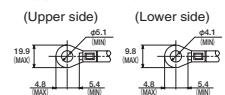

* With insulating cover

CONNECTING DEVICES

TABLE OF ASSEMBLED DIMENSIONS

TU-□ W type assembly
on punched rail
TUB-D type

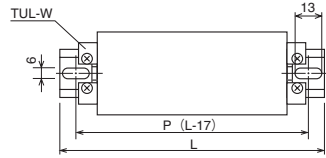

Type Pole	TU-15W,15WL			TU-20W			TU-25W,25NW,25SW			TU-25CW			Type Pole
	P	L	Rail	P	L	Rail	P	L	Rail	P	L	Rail	
1	60	77	UD-4	60	77	UD-4	60	77	UD-4	60	77	UD-4	1
2	60	77	UD-4	60	77	UD-4	60	77	UD-4	100	117	UD-6	2
3	60	77	UD-4	80	97	UD-5	80	97	UD-5	115	125	UD-7	3
4	80	97	UD-5	100	117	UD-6	80	97	UD-5	140	157	UD-8	4
5	80	97	UD-5	100	117	UD-6	100	117	UD-6	160	177	UD-9	5
6	100	117	UD-6	120	137	UD-7	120	137	UD-7	200	217	UD-11	6
7	100	117	UD-6	120	137	UD-7	120	137	UD-7	220	237	UD-12	7
8	100	117	UD-6	120	137	UD-7	140	157	UD-8	240	257	UD-13	8
9	120	137	UD-7	140	157	UD-8	140	157	UD-8	280	297	UD-15	9
10	120	137	UD-7	140	157	UD-8	160	177	UD-9	280	297	UD-15	10
11	140	157	UD-8	160	177	UD-9	160	177	UD-9	320	337	UD-17	11
12	140	157	UD-8	160	177	UD-9	180	197	UD-10	360	377	UD-19	12
13	140	157	UD-8	180	197	UD-10	200	217	UD-11	380	397	UD-20	13
14	160	177	UD-9	180	197	UD-10	200	217	UD-11	400	417	UD-21	14
15	160	177	UD-9	200	217	UD-11	220	237	UD-12	430	440	UD-22	15
16	180	197	UD-10	220	237	UD-12	220	237	UD-12	455	465	UD-24	16
17	180	197	UD-10	220	237	UD-12	240	257	UD-13	480	490	UD-25	17
18	180	197	UD-10	240	257	UD-13	240	257	UD-13	505	515	UD-26	18
19	200	217	UD-11	240	257	UD-13	260	277	UD-14	530	540	UD-28	19
20	200	217	UD-11	260	277	UD-14	280	297	UD-15	560	570	UD-29	20
21	220	237	UD-12	260	277	UD-14	280	297	UD-15	585	595	UD-30	21
22	220	237	UD-12	280	297	UD-15	300	317	UD-16	610	620	UD-32	22
23	220	237	UD-12	280	297	UD-15	300	317	UD-16	635	645	UD-33	23
24	240	257	UD-13	300	317	UD-16	320	337	UD-17				24
25	240	257	UD-13	300	317	UD-16	320	337	UD-17				25
26	260	277	UD-14	320	337	UD-17	340	357	UD-18				26
27	260	277	UD-14	320	337	UD-17	360	377	UD-19				27
28	260	277	UD-14	340	357	UD-18	360	377	UD-19				28
29	280	297	UD-15	340	357	UD-18	380	397	UD-20				29
30	280	297	UD-15	360	377	UD-19	380	397	UD-20				30
31	300	317	UD-16	360	377	UD-19	400	417	UD-21				31
32	300	317	UD-16	380	397	UD-20	400	417	UD-21				32
33	300	317	UD-16	380	397	UD-20	420	437	UD-22				33
34	320	337	UD-17	400	417	UD-21	440	457	UD-23				34
35	320	337	UD-17	400	417	UD-21	440	457	UD-23				35
36	340	357	UD-18	420	437	UD-22	460	477	UD-24				36
37	340	357	UD-18	440	457	UD-23	460	477	UD-24				37
38	340	357	UD-18	440	457	UD-23	480	497	UD-25				38
39	360	377	UD-19	460	477	UD-24	500	517	UD-26				39
40	360	377	UD-19	460	477	UD-24	500	517	UD-26				40
41	380	397	UD-20	480	497	UD-25	520	537	UD-27				41
42	380	397	UD-20	480	497	UD-25	520	537	UD-27				42
43	380	397	UD-20	500	517	UD-26	540	557	UD-28				43
44	400	417	UD-21	500	517	UD-26	540	557	UD-28				44
45	400	417	UD-21	520	537	UD-27	560	577	UD-29				45
46	420	437	UD-22	520	537	UD-27	580	597	UD-30				46
47	420	437	UD-22	540	557	UD-28	580	597	UD-30				47
48	420	437	UD-22	540	557	UD-28							48
49	440	457	UD-23	560	577	UD-29							49
50	440	457	UD-23	560	577	UD-29							50
51	460	477	UD-24	580	597	UD-30							51
52	460	477	UD-24	580	597	UD-30							52
53	460	477	UD-24										53
54	480	497	UD-25										54
55	480	497	UD-25										55
56	500	517	UD-26										56
57	500	517	UD-26										57
58	500	517	UD-26										58
59	520	537	UD-27										59
60	520	537	UD-27										60

*Rail designation is UD-□□□ for TUB-D type (Punched rail).

**If you require a DIN rail (Punched rail), please select either the standard rail TXB type (XD-□□) or the reinforced rail TXB type (KD-□□). (TU-15W only)



SCREW TYPE TERMINAL BLOCK

TU-□W TYPE

TU-□W type assembly on U-cut rail
TUB-F type

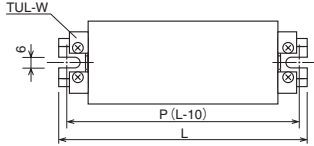









Type	TU-15W,15WL			TU-20W			TU-25W,25NW,25SW			TU-25CW			Type
	Pole	P	L	Rail	P	L	Rail	P	L	Rail	P	L	
1	55	65	UF-65	60	70	UF-70	55	65	UF-65	65	75	UF-75	1
2	60	70	UF-70	70	80	UF-80	65	75	UF-75	90	100	UF-100	2
3	70	80	UF-80	80	90	UF-90	75	85	UF-85	115	125	UF-125	3
4	75	85	UF-85	95	105	UF-105	85	95	UF-95	140	150	UF-150	4
5	85	95	UF-95	105	115	UF-115	100	110	UF-110	170	180	UF-180	5
6	95	105	UF-105	115	125	UF-125	110	120	UF-120	195	205	UF-205	6
7	100	110	UF-110	125	135	UF-135	120	130	UF-130	220	230	UF-230	7
8	110	120	UF-120	135	145	UF-145	135	145	UF-145	245	255	UF-255	8
9	115	125	UF-125	145	155	UF-155	145	155	UF-155	270	280	UF-280	9
10	125	135	UF-135	155	165	UF-165	155	165	UF-165	300	310	UF-310	10
11	135	145	UF-145	165	175	UF-175	165	175	UF-175	325	335	UF-335	11
12	140	150	UF-150	175	185	UF-185	180	190	UF-190	350	360	UF-360	12
13	150	160	UF-160	185	195	UF-195	190	200	UF-200	375	385	UF-385	13
14	155	165	UF-165	200	210	UF-210	200	210	UF-210	400	410	UF-410	14
15	165	175	UF-175	210	220	UF-220	215	225	UF-225	430	440	UF-440	15
16	175	185	UF-185	220	230	UF-230	225	235	UF-235	455	465	UF-465	16
17	180	190	UF-190	230	240	UF-240	235	245	UF-245	480	490	UF-490	17
18	190	200	UF-200	240	250	UF-250	250	260	UF-260	505	515	UF-515	18
19	195	205	UF-205	250	260	UF-260	260	270	UF-270	530	540	UF-540	19
20	205	215	UF-215	260	270	UF-270	270	280	UF-280	560	570	UF-570	20
21	215	225	UF-225	270	280	UF-280	280	290	UF-290	585	595	UF-595	21
22	220	230	UF-230	280	290	UF-290	295	305	UF-305				22
23	230	240	UF-240	290	300	UF-300	305	315	UF-315				23
24	235	245	UF-245	305	315	UF-315	315	325	UF-325				24
25	245	255	UF-255	315	325	UF-325	330	340	UF-340				25
26	255	265	UF-265	325	335	UF-335	340	350	UF-350				26
27	260	270	UF-270	335	345	UF-345	350	360	UF-360				27
28	270	280	UF-280	345	355	UF-355	365	375	UF-375				28
29	275	285	UF-285	355	365	UF-365	375	385	UF-385				29
30	285	295	UF-295	365	375	UF-375	385	395	UF-395				30
31	295	305	UF-305	375	385	UF-385	395	405	UF-405				31
32	300	310	UF-310	385	395	UF-395	410	420	UF-420				32
33	310	320	UF-320	395	405	UF-405	420	430	UF-430				33
34	315	325	UF-325	410	420	UF-420	430	440	UF-440				34
35	325	335	UF-335	420	430	UF-430	445	455	UF-455				35
36	335	345	UF-345	430	440	UF-440	455	465	UF-465				36
37	340	350	UF-350	440	450	UF-450	465	475	UF-475				37
38	350	360	UF-360	450	460	UF-460	480	490	UF-490				38
39	355	365	UF-365	460	470	UF-470	490	500	UF-500				39
40	365	375	UF-375	470	480	UF-480	500	510	UF-510				40
41	375	385	UF-385	480	490	UF-490	510	520	UF-520				41
42	380	390	UF-390	490	500	UF-500	525	535	UF-535				42
43	390	400	UF-400	500	510	UF-510	535	545	UF-545				43
44	395	405	UF-405	515	525	UF-525	545	555	UF-555				44
45	405	415	UF-415	525	535	UF-535	560	570	UF-570				45
46	415	425	UF-425	535	545	UF-545	570	580	UF-580				46
47	420	430	UF-430	545	555	UF-555	580	590	UF-590				47
48	430	440	UF-440	555	565	UF-565							48
49	435	445	UF-445	565	575	UF-575							49
50	445	455	UF-455	575	585	UF-585							50
51	455	465	UF-465	585	595	UF-595							51
52	460	470	UF-470										52
53	470	480	UF-480										53
54	475	485	UF-485										54
55	485	495	UF-495										55
56	495	505	UF-505										56
57	500	510	UF-510										57
58	510	520	UF-520										58
59	515	525	UF-525										59
60	525	535	UF-535										60

*Rail designation is UF-□pole for TUB-F type (U cut rail), (*only TU-15W type)

ACCESSORIES

LIST OF APPLICABLE ACCESSORIES

Type	Accessory	End plate	Marker strip		Marker strip case	Marker sheet	Aluminum rail		End clamp	Cover	Jumper	
												
		Applicable	Semi-applicable				Applicable	Semi-applicable	Applicable	Semi-applicable		
TU-□W TYPE	TU-15W	TUE-15WA, TUE-15WB	TUM-2	_____	TUM marker strip case 10 (top and bottom)	TU-15 marker sheet	TUB	TXB TKB	TUL-W	TXL TJL	TUC-2 TUC-2-V0	SB8RCB SB8CB
	TU-20W	TUE-20W	TUM-2 TUM-1	_____	TUM marker strip case 10 (top) TUM marker strip case 8 (bottom)	_____						
	TU-25W	TUE-25WA, TUE-25WB	TUM-13	_____	_____	TU-20 marker sheet						
	TU-25□W	_____		_____	_____							
	TU-25CW	TUE-25WA		_____	TU-25CW marker strip							

End plate

(Order unit: 100)

●TUE-□WA (Ventral side)

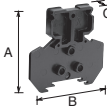

●TUE-□WB (Dorsal side)

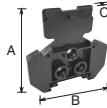

*The photo above shows the TUE-15WA and TUE-15WB. The TUE-25WA and TUE-15WB have different shapes.

Type name	TUE-15WA TUE-15WB	TUE-20W	TUE-25WA TUE-25WB
A	58	49	52
B	60	60	50
C	7	8	3

* Please use TUE-□W A, B set.

Marker strip

(Order unit: 100)

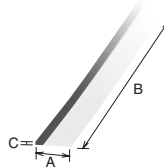

Standard thickness:
t = 1.0 mm

Type name	TUM-1* (TUM marker strip 8A ABS)	TUM-2* (TUM marker strip 10A ABS)	TUM-13	TU-25CW Marker strip
A	8	10	13	13
B	900	900	900	22.5
C	1	1	0.5	0.5

* Plate thickness t = 0.5 mm specification is available.
Type: TUM-1 0.5T (TUM marker strip 8ABS 0.5)
Type: TUM-2 0.5T (TUM marker strip 10ABS 0.5)

Marker strip case

(Order unit: 100)

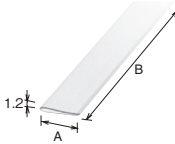

Plate thickness: t = 0.3 mm
Transparent case

Type name	TUM marker strip case 8	TUM marker strip case 10
A	8	10.2
B	1,000	1,000

Marker sheet

(Order unit: 100)

Printable area: A4-size

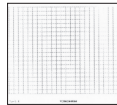

Type name	TU-15 marker sheet	TU-20 marker sheet
Pitch	8	11.5

Aluminum rail

●TUB (Fuji exclusive rail) (Order unit: 50)

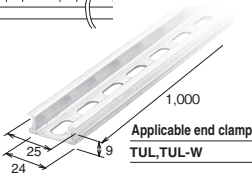
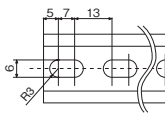

●TXB (DIN rail) (Order unit: 50)

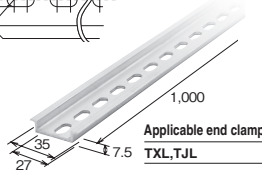
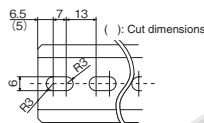

●TKB (Reinforced DIN rail) (Order unit: 20)

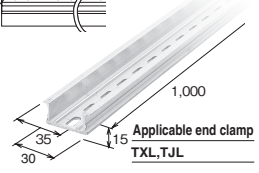



TU-□W TYPE

End clamp

(Order unit: 50)

●TUL-W (for TUB)

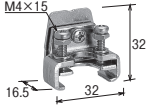

●TXL (for TXB)

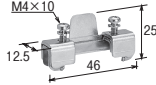

●TJL (for TXB)

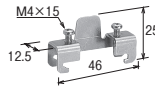

Cover

(Order unit: 20)

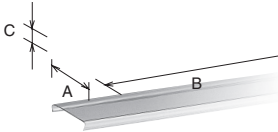

Type name	TUC-2 TUC-2-V0	TUC-8 TUC-8-V0	TU-25CW cover
A	35	50	50
B	1,000	1,000	22.5
C	5.6	7	7

* The end "V0" is a flame retardant grade UL94V-0 specification product.

Jumper

(Order unit: 10)

With insulation coat	2 poles	SB8CB-2	SB8RCB-2	SB11.5CB-2
	12 poles	SB8CB-12	SB8RCB-12	SB11.5CB-12
Dimensions				

* For pole counts other than those listed above, please contact us.

Name plate mount

(Order unit: 50)

●TX NP mount S



●TX NP mount lens



* The NP mount can be attached to TXL (end clamp).



(Assembled state)

Rail cap

(Order unit: 100)

●Cap for DIN rail
TXB CAP-PVC

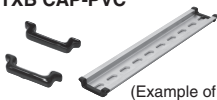

(Example of usage)

●Cap for DIN rail (High-strength type)
TKB CAP-PVC

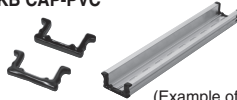

(Example of usage)

●Cap for Fuji exclusive rail
TUB CAP-PVC



(Example of usage)

* Only single product sale.