

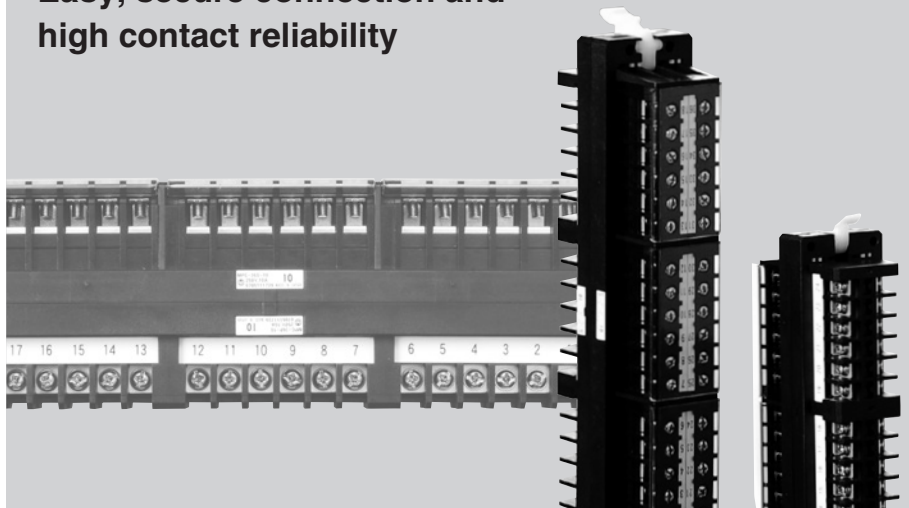

RECTANGULAR CONNECTOR

MPC-TYPE

**Easy, secure connection and
high contact reliability**



FEATURES

Coded plug connector enables separated use

36 pattern pin code structure at each end of connector prevents wrong plugging of connectors, which enables separated use as applications (circuits).



Secure lock and easy removal

Secure lock is available with levers, and plug can be removed easily by release structure on the levers in spite of their lots-units (24 or 36).

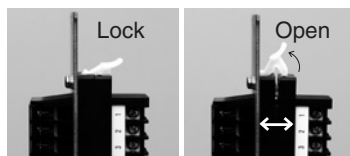

High contact reliability by the 4-point contact (silver plating)

Multipoint contacts, high conductive silver plating enable secure contact reliability.

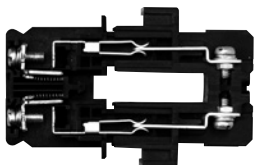

Lots-units, high current-carrying capacity

High contact pressure can carry 10A (continuous), 200A (2 sec), and 300A (3 sec) at all poles in spite of 24 or 36 lots-units.

High anti-flammability grade plastic

PBT plastic (class UL94 V-0) of base portion and modified PPE plastic (class UL94 V-1) of unit portion are adopted for anti-flammability.

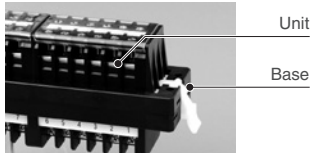

Up-screw structure of socket

Up-screw structure of socket improves speed of wiring and prevents screws dropping.



Safety structures

Protective structures on contact points (plug cover and terminal cover) are adopted for improving safety.

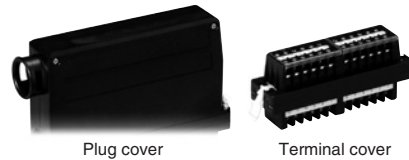

Wide compatibility by their screw terminal

General-purpose screw enables easy change or adding wires by only general-purpose crimp terminal without special tools.

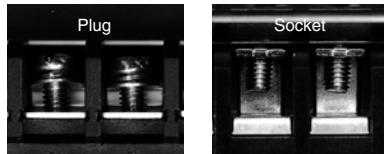

Various accessories

Various accessories such as mark label and terminal cover are available. (All accessories except plug cover are equipped as standard)

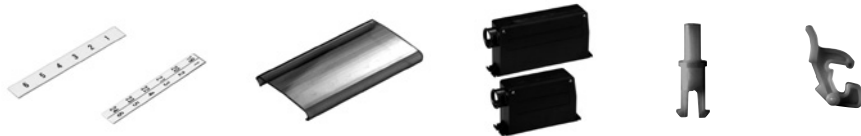

SPECIFICATIONS (RATING, PERFORMANCE / NORMAL SERVICE CONDITION)

Standard : IEC 60947-7-1

Specification	Type	MPC-24	MPC-36
Rated isolation voltage (Ui)		250V	
Rated impulse withstand voltage		±4kV / 5 times for each pole (1.2 / 50μs)	
Rated current-carrying capacity (Ith)		10A	
Applicable wire size		2.5 mm ²	
Insulation resistance		1,000M Ω or more	
Power-Frequency withstand voltage		2,500V AC / 1 min.	
Short-time current		200A / 2 sec. 300A / 1 sec.	
Vibration resistance		Frequency range: 10 to 55Hz Amplitude: 1.5mm Time: 2 hours (3 axial directions)	
Shock resistance		500m/s ² (6 directions)	
Insertion / Extraction load		300N or less	
Ambient operating temperature		-20 to 50°C	
Storing temperature		-40 to 85°C	
Relative humidity		45 to 85%	
Altitude		2,000 m or less	
Panel thickness		1.6 to 3.2mm	



MPC-TYPE

HOW TO ORDER

Socket and Plug set

MPC - 24 P S C - 12

① ② ③ ④ ⑤ ⑥

No.	Item	Code	Detail	Remarks
①	Basic type	MPC	MPC type	Socket:up-screw Plug:normal screw
②	No. of poles	24	24 poles	
		36	36 poles	
③	Plug form	P	Plug	
④	Socket form	S	Socket	
⑤	Cover	C	Side type	Leading wires through side hole (only for plug)
⑥	Coded plug and socket	1 to 36 or blank	Key No.	See C215 "Plug and socket coding system"

Socket

MPC - 24 S - 12

① ② ③ ④

No.	Item	Code	Detail	Remarks
①	Basic type	MPC	MPC type	Up-screw
②	No. of poles	24	24 poles	
		36	36 poles	
③	Form	S	Socket	
④	Coded plug and socket	1 to 36 or blank	Key No.	See C215 "Plug and socket coding system"

Plug

MPC - 24 P C - 12

① ② ③ ④ ⑤

No.	Item	Code	Detail	Remarks
①	Basic type	MPC	MPC type	Normal screw
②	No. of poles	24	24 poles	
		36	36 poles	
③	Form	P	Plug	
④	Cover	C	Side type	Leading wires through side hole (only for plug)
⑤	Coded plug and socket	1 to 36 or blank	Key No.	See C215 "Plug and socket coding system"

MOUNTING HOLE

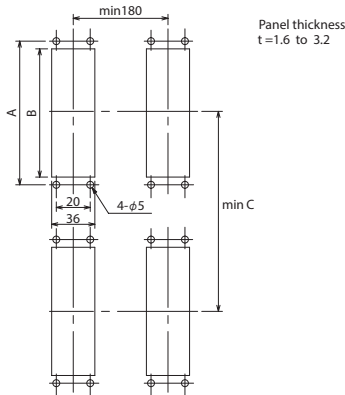

	24 poles	36 poles
A	152	217
B	140	205
C	210	280

(mm)

DIMENSION

MPC-24-PSC-□ (24 poles)

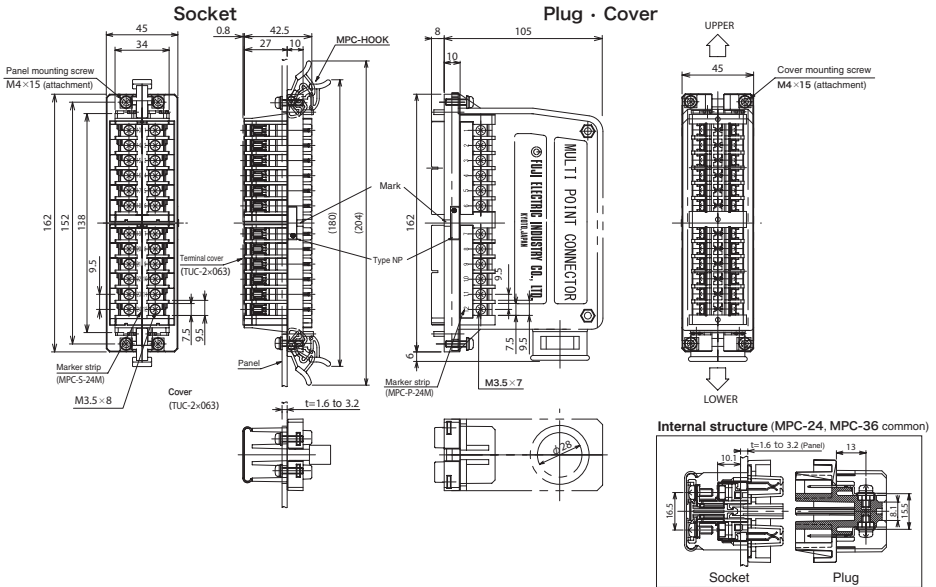

MPC-36-PSC-□ (36 poles)

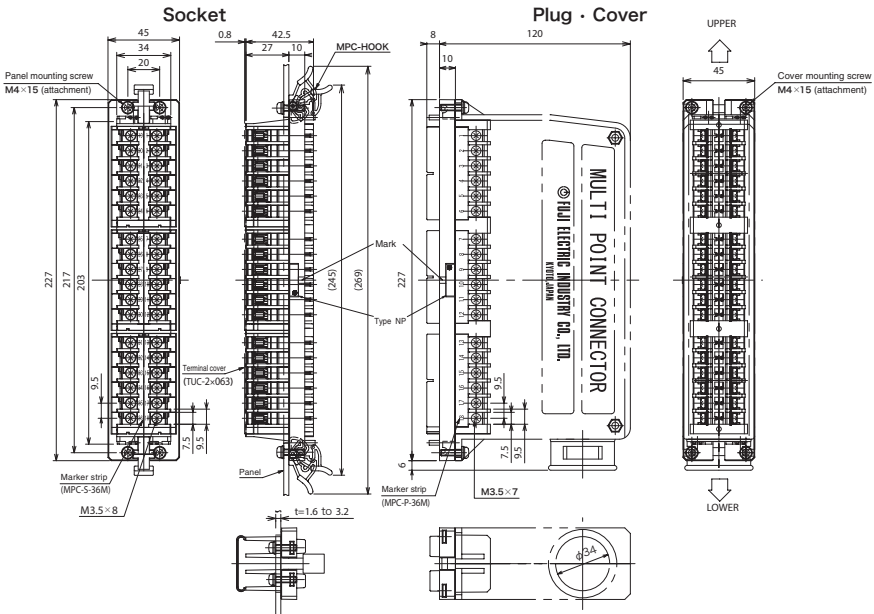



RECTANGULAR CONNECTOR

MPC-TYPE

PLUG AND SOCKET CODING SYSTEM

Key No. can be selected from following 1 to 36.

Different key No. plug and socket cannot be connected by intervening each pin, which enables separated use as applications (circuits).

● When plug and socket key No. are same

● When plug and socket key No. are different

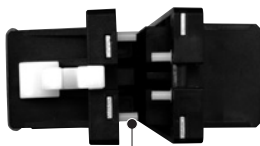

Incorrect-insertion preventing pin

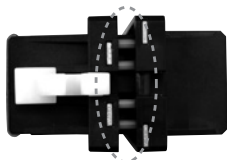

When each key No. is same

Pins and holes between plug and socket meet each other, and can be connected.

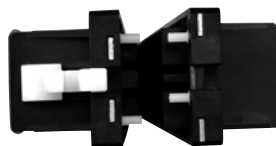

When each key No. is different

Pins and holes between plug and socket intervene each other, and cannot be connected.

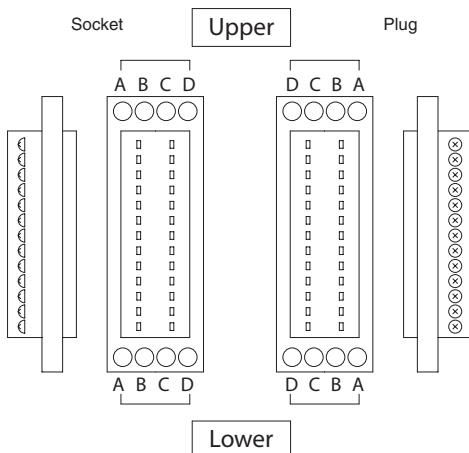

Key No.

		Socket		Plug		No.			Socket		Plug	
Position		A B C D		D C B A			Position		A B C D		D C B A	
1	Upper	○ ○ ○ ○		○ ○ ○ ○		19	Upper	○ ○ ○ ○	○ ○ ○ ○		○ ○ ○ ○	
	Lower	○ ○ ○ ○		○ ○ ○ ○			Lower	○ ○ ○ ○	○ ○ ○ ○		○ ○ ○ ○	
2	Upper	○ ○ ○ ○		○ ○ ○ ○		20	Upper	○ ○ ○ ○	○ ○ ○ ○		○ ○ ○ ○	
	Lower	○ ○ ○ ○		○ ○ ○ ○			Lower	○ ○ ○ ○	○ ○ ○ ○		○ ○ ○ ○	
3	Upper	○ ○ ○ ○		○ ○ ○ ○		21	Upper	○ ○ ○ ○	○ ○ ○ ○		○ ○ ○ ○	
	Lower	○ ○ ○ ○		○ ○ ○ ○			Lower	○ ○ ○ ○	○ ○ ○ ○		○ ○ ○ ○	
4	Upper	○ ○ ○ ○		○ ○ ○ ○		22	Upper	○ ○ ○ ○	○ ○ ○ ○		○ ○ ○ ○	
	Lower	○ ○ ○ ○		○ ○ ○ ○			Lower	○ ○ ○ ○	○ ○ ○ ○		○ ○ ○ ○	
5	Upper	○ ○ ○ ○		○ ○ ○ ○		23	Upper	○ ○ ○ ○	○ ○ ○ ○		○ ○ ○ ○	
	Lower	○ ○ ○ ○		○ ○ ○ ○			Lower	○ ○ ○ ○	○ ○ ○ ○		○ ○ ○ ○	
6	Upper	○ ○ ○ ○		○ ○ ○ ○		24	Upper	○ ○ ○ ○	○ ○ ○ ○		○ ○ ○ ○	
	Lower	○ ○ ○ ○		○ ○ ○ ○			Lower	○ ○ ○ ○	○ ○ ○ ○		○ ○ ○ ○	
7	Upper	○ ○ ○ ○		○ ○ ○ ○		25	Upper	○ ○ ○ ○	○ ○ ○ ○		○ ○ ○ ○	
	Lower	○ ○ ○ ○		○ ○ ○ ○			Lower	○ ○ ○ ○	○ ○ ○ ○		○ ○ ○ ○	
8	Upper	○ ○ ○ ○		○ ○ ○ ○		26	Upper	○ ○ ○ ○	○ ○ ○ ○		○ ○ ○ ○	
	Lower	○ ○ ○ ○		○ ○ ○ ○			Lower	○ ○ ○ ○	○ ○ ○ ○		○ ○ ○ ○	
9	Upper	○ ○ ○ ○		○ ○ ○ ○		27	Upper	○ ○ ○ ○	○ ○ ○ ○		○ ○ ○ ○	
	Lower	○ ○ ○ ○		○ ○ ○ ○			Lower	○ ○ ○ ○	○ ○ ○ ○		○ ○ ○ ○	
10	Upper	○ ○ ○ ○		○ ○ ○ ○		28	Upper	○ ○ ○ ○	○ ○ ○ ○		○ ○ ○ ○	
	Lower	○ ○ ○ ○		○ ○ ○ ○			Lower	○ ○ ○ ○	○ ○ ○ ○		○ ○ ○ ○	
11	Upper	○ ○ ○ ○		○ ○ ○ ○		29	Upper	○ ○ ○ ○	○ ○ ○ ○		○ ○ ○ ○	
	Lower	○ ○ ○ ○		○ ○ ○ ○			Lower	○ ○ ○ ○	○ ○ ○ ○		○ ○ ○ ○	
12	Upper	○ ○ ○ ○		○ ○ ○ ○		30	Upper	○ ○ ○ ○	○ ○ ○ ○		○ ○ ○ ○	
	Lower	○ ○ ○ ○		○ ○ ○ ○			Lower	○ ○ ○ ○	○ ○ ○ ○		○ ○ ○ ○	
13	Upper	○ ○ ○ ○		○ ○ ○ ○		31	Upper	○ ○ ○ ○	○ ○ ○ ○		○ ○ ○ ○	
	Lower	○ ○ ○ ○		○ ○ ○ ○			Lower	○ ○ ○ ○	○ ○ ○ ○		○ ○ ○ ○	
14	Upper	○ ○ ○ ○		○ ○ ○ ○		32	Upper	○ ○ ○ ○	○ ○ ○ ○		○ ○ ○ ○	
	Lower	○ ○ ○ ○		○ ○ ○ ○			Lower	○ ○ ○ ○	○ ○ ○ ○		○ ○ ○ ○	
15	Upper	○ ○ ○ ○		○ ○ ○ ○		33	Upper	○ ○ ○ ○	○ ○ ○ ○		○ ○ ○ ○	
	Lower	○ ○ ○ ○		○ ○ ○ ○			Lower	○ ○ ○ ○	○ ○ ○ ○		○ ○ ○ ○	
16	Upper	○ ○ ○ ○		○ ○ ○ ○		34	Upper	○ ○ ○ ○	○ ○ ○ ○		○ ○ ○ ○	
	Lower	○ ○ ○ ○		○ ○ ○ ○			Lower	○ ○ ○ ○	○ ○ ○ ○		○ ○ ○ ○	
17	Upper	○ ○ ○ ○		○ ○ ○ ○		35	Upper	○ ○ ○ ○	○ ○ ○ ○		○ ○ ○ ○	
	Lower	○ ○ ○ ○		○ ○ ○ ○			Lower	○ ○ ○ ○	○ ○ ○ ○		○ ○ ○ ○	
18	Upper	○ ○ ○ ○		○ ○ ○ ○		36	Upper	○ ○ ○ ○	○ ○ ○ ○		○ ○ ○ ○	
	Lower	○ ○ ○ ○		○ ○ ○ ○			Lower	○ ○ ○ ○	○ ○ ○ ○		○ ○ ○ ○	

When no key code: 8 pins are equipped as no mounted condition.

EASY REMOVAL STRUCTURE

The structure that a hook lifts the end of the connector makes removal of the connector easy.

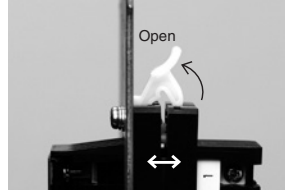
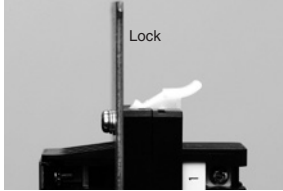

ACCESSORIES

Marker strip

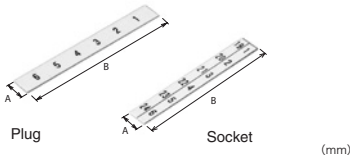

For	Type	A	B	Thickness	Set No.
MPC-24 plug	MPC-P-24M	8	63	0.5	4
MPC-36 plug	MPC-P-36M				6
MPC-24 socket	MPC-S-24M	8	57	0.5	2
MPC-36 socket	MPC-S-36M				3

Terminal Cover

●TUC-2 × 063

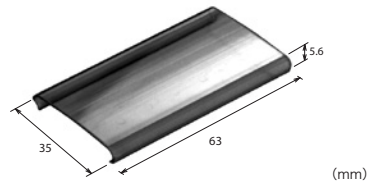

Plug cover (24P)

●MPC-24C

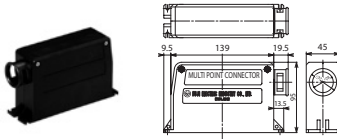

Plug cover (36P)

●MPC-36C

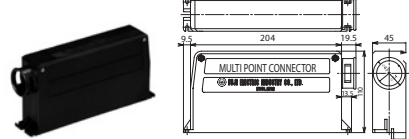

Screw set for mounting plug cover / panel

MPC-VISSET



Incorrect-insertion preventing pin

MPC-PIN



Hook for lock

MPC-HOOK

