



TG TYPE



FEATURES

- The structure combining up-screw method and clamp method makes simply wiring work.
- Up-screw terminal side is up-screw structure like the TX type.
- Wiring on the clamp terminal side is inserted from the top. This structure saves wiring space, and enables quick removal of the wiring.

SPECIFICATIONS (RATINGS, PERFORMANCE)

Specification	Type	TG-3.5
Rated insulation voltage (UI)		250V
Rated current-carrying capacity (Ith)		10A
Max. wire size		2mm ²
Screw size		M3.5x7.5
Withstand voltage		2,000V AC / 1 min.
Lightning impulse		±4kV / 3 times for each pole (1.2 / 50 μs)
Ambient operating temperature		-20 to 50°C
Storing temperature		-40 to 85°C
Altitude		2,000 m or less

How to order of terminal blocks

TG - 3.5 × 10 UD

① ② ③

No.	Item	Code	Detail		Remark
①	Basic type	TG-3.5	Applicable wire size (mm ²)	2	Unit tickness : 8mm
②	No. of poles	1 to max.	1 to 70		Max. pole No. is less than 600mm of rail length.
③	Rail	UD	TUB-D rail type	Punched rail	(Recommended maximum length : 600mm)
		UF	TUB-F rail type	U-cut rail	(Recommended maximum length : 600mm)

STANDARD PRODUCTS

TG-3.5 (10A)

Applicable wire size: 0.75 to 2.0mm²

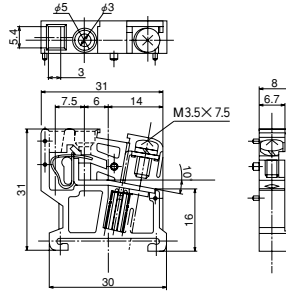
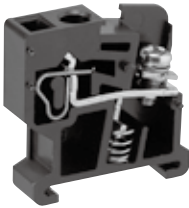

●Applicable accessories

End plate	TGE-3.5
Standard marker strip	TUM-1
Standard rail	TUB
End clamp	TUL

●Applicable crimp terminal

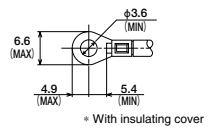
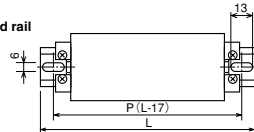

TABLE OF ASSEMBLED DIMENSIONS

TG-3.5 type assembly on punched rail TUB-D type

Punched rail



Pole	2	3	4	6	8	10	12	14	16	18	20	22	24	26
P	40	40	60	80	80	100	120	140	160	160	180	200	220	240
L	57	57	77	97	97	117	137	157	177	177	197	217	237	257
Rail	UD-3	UD-3	UD-4	UD-5	UD-5	UD-6	UD-7	UD-8	UD-9	UD-9	UD-10	UD-11	UD-12	UD-13

TG-3.5 type assembly on U-cut rail TUB-F type

U-cut rail

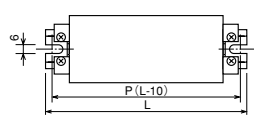

Pole	2	3	4	6	8	10	12	14	16	18	20	22	24	26
P	45	50	60	75	90	110	125	140	155	170	190	205	220	235
L	55	60	70	85	100	120	135	150	165	180	200	215	230	245
Rail	UF-55	UF-60	UF-70	UF-85	UF-100	UF-120	UF-135	UF-150	UF-165	UF-180	UF-200	UF-215	UF-230	UF-245



TG TYPE

ACCESSORIES

End plate

(Order unit: 100)

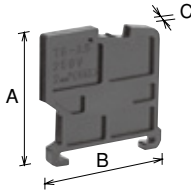

Type name	TGE-3.5
A	31
B	31
C	3

Marker strip

(Order unit: 100)

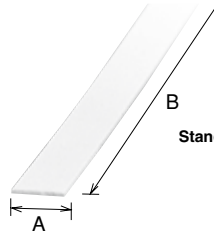

Standard thickness:
t = 1.0 mm

Type name	TUM-1
A	8
B	900

Marker strip case

(Order unit: 100)

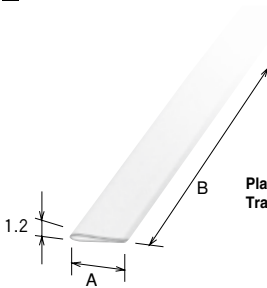
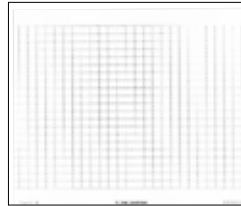

Plate thickness: t = 0.3 mm
Transparent case

Type name	TUM marker strip case 8
A	8
B	1,000

Marker sheet

(Order unit: 100)



Type name	TU-15 marker sheet
Pitch	8

End clamp

(Order unit: 50)

●TUL (for TUB)

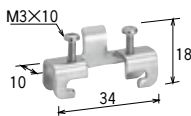

●TUL-W (for TUB)

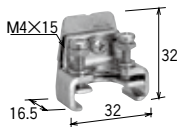

Aluminum rail

(Order unit: 50)

●TUB

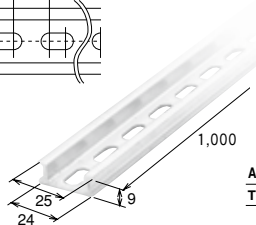
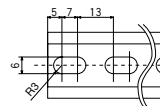

Applicable end clamp
TUL, TUL-W

CONNECTING DEVICES

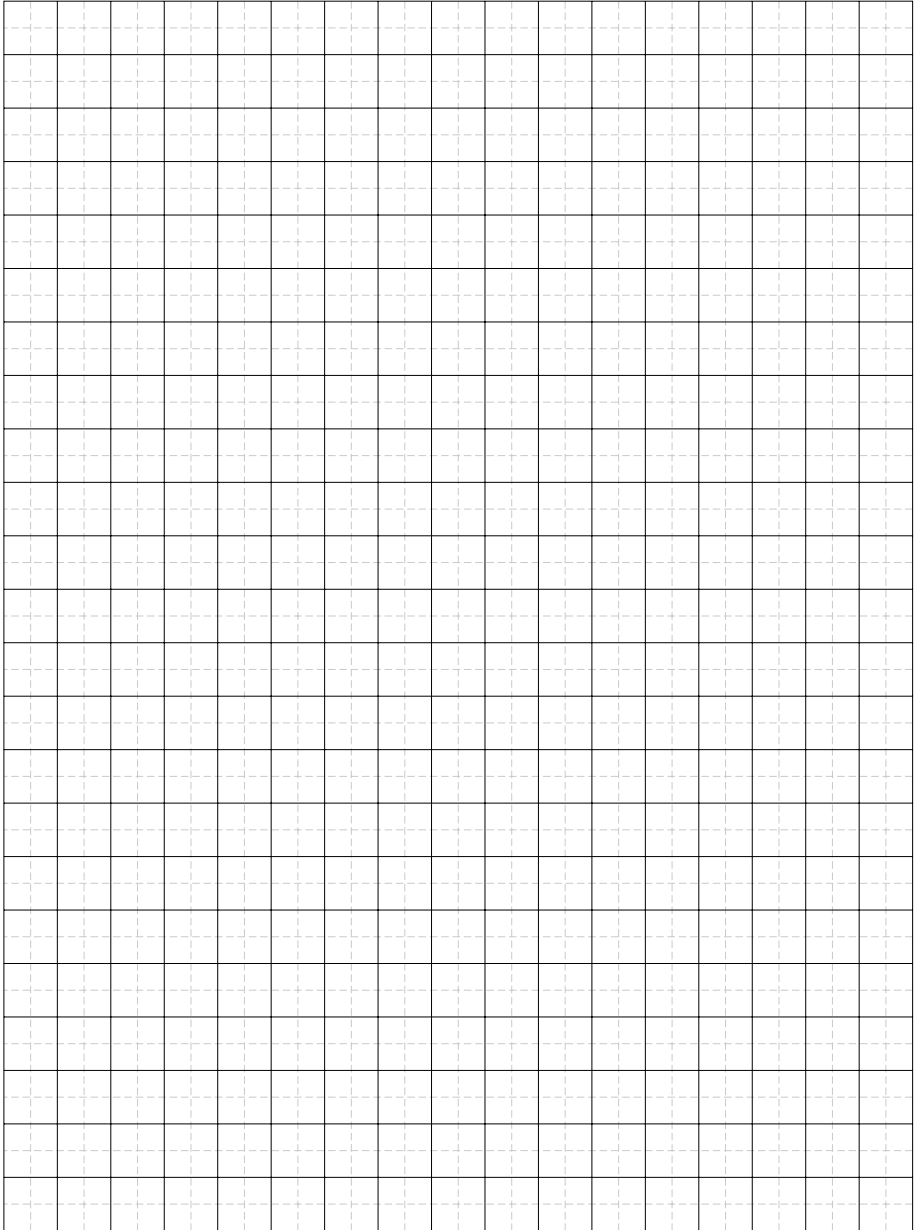

A SWITCH

PILOT LAMP &
B INDICATOR

**C CONNECTING
DEVICES**

D ELECTRONIC
DEVICES

E CONTROL
CENTER PARTS